



Electrolux

Blast Chillers CW Blast Chiller Crosswise - 15 kg

ITEM #

MODEL #

NAME #

SIS #

AIA #



Electrolux



Blast Chillers CW

Blast Chiller Crosswise - 15 kg

726620 (RBC061)

Blast chiller 15kg, for 6x1/1GN crosswise oven. Preset customised programming possible. Supplied with a single sensor probe

Short Form Specification

Item No.

For 6 GN1/1 or 600x400 mm trays. Load capacity: chilling 15 kg; (UK guidelines). Main components in 304 AISI stainless steel. Internal rounded corners and drain. Built-in refrigeration unit. Automatic detection of food probe insertion. Automatic and Manual defrost. Blast chilling real residual time estimation (A.R.T.E.). Turbo cooling function. Specific cycles for ice cream. Evaporator with anti-rust protection. Digital temperature and time display. HACCP and Service alarms with data logging. Operating air temperature: +90 -12°C. For ambient temperatures up to 32°C. Cyclopentane insulation (HCFC, CFC and HFC free). R134a refrigerant gas (HCFC and CFC free).

Main Features

- Blast Chilling cycle: 15 kg from 90°C up to 3°C in less than 90 minutes.
- Soft Chilling (air temperature 0°C).
- Hard Chilling (air temperature -12°C).
- Holding at 3 °C for chilling, automatically activated at the end of each cycle, to save energy and maintain the target temperature (manual activation is also possible).
- Turbo cooling: chiller works continuously at the desired temperature; ideal for continuous production.
- Control unit provides two large displays to read out: time, core temperature, cycle countdown, alarms, service information.
- Two customizable cycles (P1 & P2) for each operating mode, allowing to set the time and air temperature. These programs can be converted into ice-cream specialized cycles (shape maintenance and holding).
- All information related to the different operating models are recorded: date, time, cycle, core temperature, holding temperature, HACCP accordance.
- Performance guaranteed at ambient temperatures of +32 °C.
- Probe-driven cycles feature ARTE (Algorithm for Remaining Time Estimation) to make planning the activities easier.
- Single sensor core probe as standard.

Construction

- High density polyurethane insulation, 60 mm thickness, HCFC free.
- Magnetic, easy-to-remove heated gaskets.
- 304 AISI stainless steel construction throughout.
- Seamless hygienic inner cell with all rounded corners for easy cleaning.
- Swing hinged front panel for easy service access to main components.
- Ventilator swinging hinged panel for access to the evaporator for cleaning.
- R134a gas in refrigeration circuit.
- No water connections required.
- Waste water can be plumbed into drain, but can also be collected in an optional waste container.

APPROVAL:



Electrolux

Blast Chillers CW Blast Chiller Crosswise - 15 kg

Included Accessories

- 1 of 1 extra single-sensor probe for blast chiller and blast chiller&freezers PNC 880213

Optional Accessories

- Kit for HACCP advanced connection for LW and CW blast chiller&freezer PNC 880183 ☐
- 3-sensor probe for blast chiller and blast chiller/freezers PNC 880212 ☐
- 1 extra single-sensor probe for blast chiller and blast chiller&freezers PNC 880213 ☐
- Rilsan grid 600x400mm PNC 880864 ☐
- Plastic coated grid 1/1GN PNC 881061 ☐
- 4 wheels for blast chillers and blast chiller/freezers PNC 881097 ☐
- Kit for stacking 6x1/1GN convection oven and 15kg blast chillers and blast chiller&freezers PNC 881528 ☐
- Printer for HACCP basic version for self service units PNC 881532 ☐
- Pair of 1/1GN AISI 304 stainless steel grids PNC 921101 ☐



**Blast Chillers CW
Blast Chiller Crosswise - 15 kg**

The company reserves the right to make modifications to the products without prior notice. All information correct at time of printing.

2014.06.23



Electrolux

Blast Chillers CW Blast Chiller Crosswise - 15 kg

Front

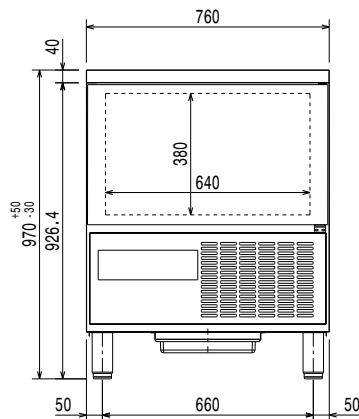

Top

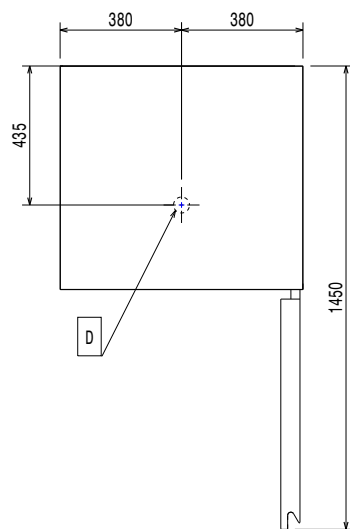

- = Remote electrical connection
ED
= Electrical connection
EI
= Refrigerant Outlet
RO

Side

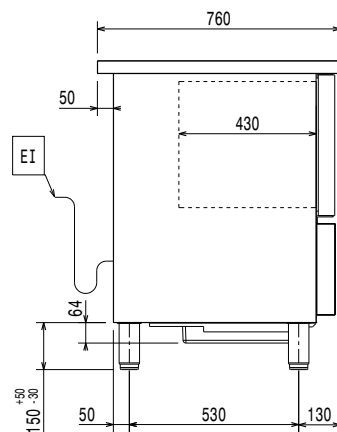

Electric

Supply voltage:

726620 (RBC061)

230 V/1N ph/50 Hz

Connected load:

0.854 kW

Circuit breaker required

Installation

Clearance:

5 cm on sides and back.

Please see and follow detailed installation instructions provided with the unit

Capacity

GN:

6 - 1/1 containers

Max load capacity:

15 kg

Key Information

External dimensions, Height	970 mm
External dimensions, Width	760 mm
External dimensions, Depth	760 mm
Net weight:	95 kg
Shipping weight:	105 kg
Shipping volume:	0.81 m ³

Refrigeration Data

Refrigerant type:	R134a
Refrigeration power:	707 W
Refrigeration power at evaporation temperature:	-5 °C
Refrigerant weight:	800 g

**Blast Chillers CW
Blast Chiller Crosswise - 15 kg**

The company reserves the right to make modifications to the products without prior notice. All information correct at time of printing.

2014.06.23

