

Bar Bottle Coolers

Standard Black, Hinged Door(s)

BAR1



BAR2

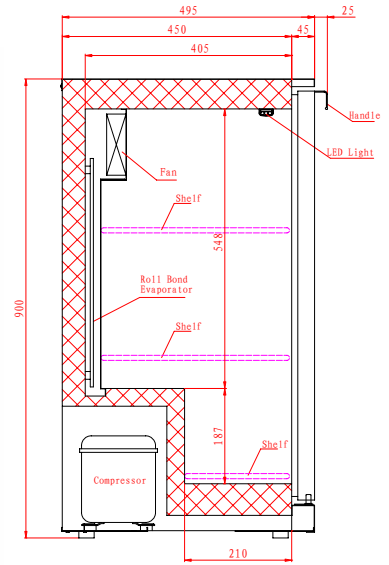

Shelf size

BAR1: 490(W) x 360(D) mm

BAR2: 395(W) x 330(D) mm

BAR3: side 395(W) x 330(D) mm,
centre 445(W) x 330(D) mm



BAR3



FEATURES

Black laminated exterior; Aluminium stippled interior

Self closing, double glazed door(s)

Heavy duty adjustable shelves

2 shelves per door

Lock fitted as standard

Internal LED illumination

Replaceable door gasket

TECHNICAL SPECIFICATIONS

Controller: Digital controller with temperature display

Cooling: Fan assisted

Defrost: Automatic

Refrigerant: R600a

Climate Class: 4

Temperature Range: +4°C ~ +12°C

Power Supply: 13amp

MODEL	DOOR	CAPACITY (Bottles*)	GROSS CAPACITY	EXT. DIMENSIONS (H x W x D mm)	POWER CONSUMPTION	DECIBELS	WEIGHT (kg)	RRP
BAR1	1	130	130L	900 x 598 x 520	165W	53dBA	44	
BAR2	2	182	200L	900 x 903 x 520	185W	54dBA	59	
BAR3	3	293	310L	900 x 1353 x 520	320W	59dBA	91	

* based on 275ml bottles

Note: fully opened doors increase width by 5mm each side



See page 340 for accessories

