

Compact Gastronorm Counters with Granite Worktop

700mm Depth

BCC2-GR-TOP



BCC3-GR-TOP

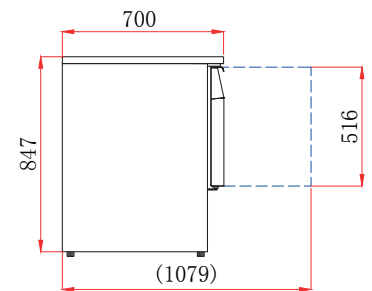
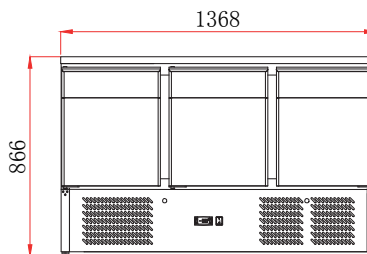
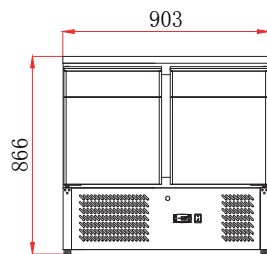

FEATURES

- High grade AISI 304 stainless steel exterior & interior
- Attractive granite worktop
- Internal corners rounded to aid cleaning
- Self closing doors
- 1 x adjustable GN1/1 shelf per door
- Adjustable feet
- Replaceable door gasket
- 35mm insulation
- Easily removable condenser filter for cleaning

TECHNICAL SPECIFICATIONS

Controller:	Dixell controller
Cooling:	Fan assisted
Defrost:	Automatic
Refrigerant:	R600a (BCC2-GR-TOP) R290 (BCC3-GR-TOP)
Climate Class:	4
Temperature Range:	+2°C ~ +8°C
Decibels:	42dBA
Power Supply:	13amp

MODEL	DOOR	GROSS CAPACITY	EXT. DIMENSIONS (H x W x D mm)	ENERGY RATING	POWER CONSUMPTION	KWH /ANNUM	WEIGHT (kg)	RRP
BCC2-GR-TOP	2	240L	866 x 903 x 700	C	170W	991	136	
BCC3-GR-TOP	3	368L	866 x 1368 x 700	D	240W	1432	155	



See page 336 for full GN container range

