

## CK5502AA DLUX Commercial Glasswasher - Drain Pump



Made in Italy



Easy Operation



Low Water Consumption



Accept  
500 x 500mm  
baskets

<b>External Dimensions</b>	W600 x D610 x H820mm
<b>Packed Dimensions</b>	W670 x D740 x H1020mm
<b>Electric Load</b>	3.65kW (Upgradable to 5.65kW)
<b>Electric Connection</b>	230V/ 50Hz
<b>Interior/ Exterior</b>	AISI 304 Grade Stainless Steel
<b>Wash Temperature</b>	55 - 65°C
<b>Rinse Temperature</b>	80 - 90°C
<b>Water Consumption</b>	3.3 Litres Per Cycle
<b>Wash Tank Capacity</b>	33 Litres
<b>Boiler Capacity</b>	5.8 Litres
<b>Water Supply Min / Max</b>	2 - 3 bar
<b>Net Weight</b>	67kg

### Caterkwik Ltd

The Lakeland Catering Centre  
Newlands  
Ulverston  
Cumbria  
LA12 7QQ

01229 480001

[info@caterkwik.co.uk](mailto:info@caterkwik.co.uk)

## CK5502AA DLUX Commercial Glasswasher - Drain Pump

### Accessories Included

- 1 x yellow cutlery container
- 1 x 240mm yellow basket
- 1 x 48 cup blue basket

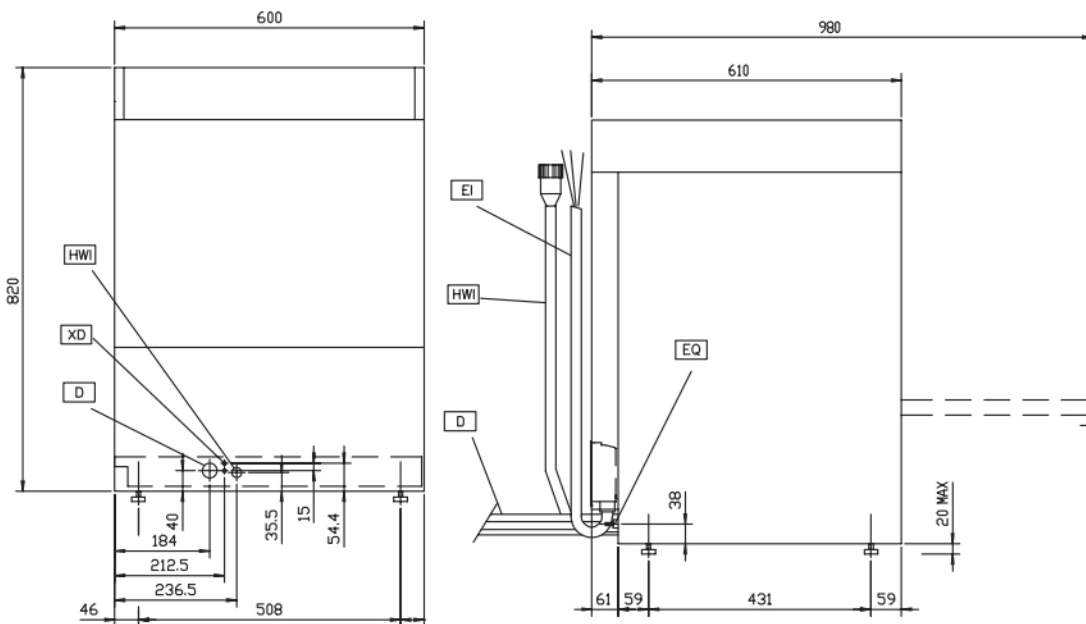
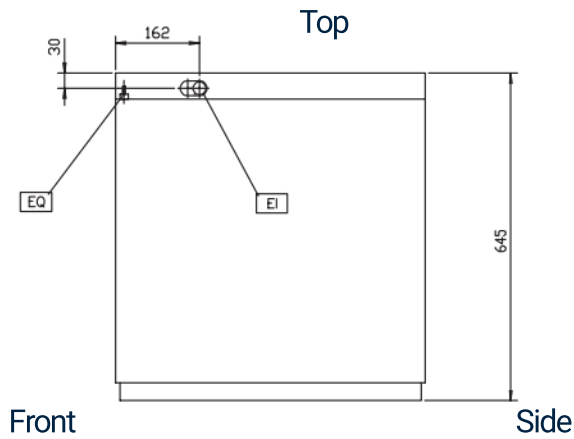

- |                            |                           |
|----------------------------|---------------------------|
| D = Drain                  | XD = Detergent Connection |
| EI = Electrical Connection | XR = Rinse Aid Connection |
| EO = Electrical Outlet     |                           |
| EQ = Equipotential Screw   |                           |
| HWI = Hot Water Inlet      |                           |
| V = Air Vents              |                           |

Caterkwik Ltd

The Lakeland Catering Centre  
Newlands  
Ulverston  
Cumbria  
LA12 7QQ

01229 480001

info@caterkwik.co.uk