

CATER-WASH

12kg Washing Machine - Instruction Manual

Model: **CK8512**



To avoid risk of accidents or damage to the appliance, it is essential to read these instructions before it is installed and used for the first time.

197
kWh/ annum



79_{db}

Caterkwik Ltd

The Lakeland Catering Centre
Newlands
Ulverston
Cumbria
LA12 7QQ

01229 480001

info@caterkwik.co.uk

CONTENTS

SAFETY INSTRUCTIONS

■ Safety Instructions	2
-----------------------------	---

INSTALLATION

■ Product Description	8
■ Installation	9

OPERATIONS

■ Quick Start	12
■ Before Each Wash.....	13
■ Detergent Dispenser	14
■ Control Panel	15
■ Options.....	17
■ Other Functions	19
■ Programmes.....	21
■ Washing Programmes Table	22

MAINTENANCE

■ Cleaning And Care	24
■ Trouble Shooting	27
■ Technical Specifications	28
■ Product Fiches	29

SAFETY INSTRUCTIONS

■ Safety Instructions

For your safety, the information in this manual must be followed to minimize the risk of fire or explosion, electric shock, or to prevent property damage, personal injury or loss of life.

Explanation of the symbols:

Warning!

This combination of symbol and signal word indicates a potentially dangerous situation which may result in death or serious injuries unless it's avoided.

Caution!

This combination of symbol and signal word indicates a potentially dangerous situation which may result in slight or minor injuries or damage to property and the environment.

Note!

This combination of symbol and signal word indicates a potentially dangerous situation which may result in slight or minor injuries.

Warning!

Electric shock!

- If the supply cord is damaged, it must be replaced by the manufacturer, its service agent or similarly qualified persons in order to avoid a hazard.
- The new hose-sets supplied with the appliance are to be used. Old hose-sets should not be reused.
- Before any maintenance to the device, unplug the appliance from the mains.

SAFETY INSTRUCTIONS

- Always unplug the machine and turn off the water supply after use. The max. inlet water pressure is 1Mpa, the min. inlet pressure is 0.05 Mpa.
- To ensure your safety, power plug must be inserted into an earthed three-pole socket. Check carefully and make sure that your socket is properly and reliably earthed.
- Water and electrical devices must be connected by a qualified technician in accordance with the manufacturer's instructions and local safety regulations.
- Unplug the machine from the power socket before cleaning or carrying out maintenance.
- Do not use any socket with rated current less than that of appliance. Never pull out power plug with wet hands.
- Please remember to disconnect water and power supply immediately after the clothes are washed.

Risk to children!

- The appliance can be used by children aged from 8 years and above and persons with reduced physical, sensory or mental capabilities or lack of experience and knowledge if they have been given supervision or instruction concerning use of the appliance in a safe way and understand the hazards involved. Children shall not play with the appliance. Cleaning and user maintenance shall not be made by children without supervision.
- Children of less than 3 years old should be supervised to ensure that they do not play with appliance.
- Animals and children may climb into the machine. Check the machine before every operation.
- Children should be supervised that they do not play with the appliance.

SAFETY INSTRUCTIONS

- Glass door may be very hot during the operation. Keep children and pets far away from the machine during the operation.
- Remove all packaging and transport bolts before using the appliance. Otherwise, serious damage may result.

Risk of explosion!

- Do not wash or dry articles that have been cleaned in, washed in, soaked in, or dabbed with combustible or explosive substances (such as wax, oil, paint, gasoline, degreasers, dry-cleaning solvents, kerosene, etc.) This may result in fire or explosion.
- The washer is not to be used if industrial chemicals have been used for cleaning.

⚠ Caution!

Installing the product!

- This appliance is for indoor use only.
- The openings must not be obstructed by carpet.
- The appliance shall not be installed in a bath room or very wet rooms as well as in the rooms with explosive or caustic gases.
- This appliance can only be connected to the cold water supply.

SAFETY INSTRUCTIONS

- The plug must be accessible after installation.
- The appliance shall not be installed in a humid place.
- Remove all packages and transport bolts before using the appliance. Otherwise, serious damage may result.

Risk of damaging the appliance!

The product is only for home use and is only designed for textiles suitable for machine washing and drying. Do not climb up and sit on the top cover of the machine. Do not lean against machine door.

Caution when Handling the Machine:

1. Transport bolts should be reinstalled to the machine by a competent person.
2. The accumulated water should be drained out of the machine.
3. Handle the machine carefully. Never hold protruded parts on the machine while lifting. The machine door can not be used as the handle during lifting.
4. This appliance is heavy. Transport with care.

Please do not close the door with excessive force. If it is found difficult to close the door, please check the clothes are not causing obstruction and are distributed well. It is forbidden to wash carpets.

Operating the appliance!

SAFETY INSTRUCTIONS

- Before using the washing machine, the product should be calibrated. (See calibration on page 12).
- Before washing clothes for the first time, you should run a wash cycle without clothes.
- Flammable and explosive or toxic solvents are forbidden. Gasoline and alcohol etc. Should not be used as detergents. Please only select the detergents suitable for machine washing.
- Make sure all clothes pockets are emptied. Sharp and rigid items such as coins, brooches, nails ,screws or stones etc. may cause serious damage to this machine.
- Please check whether the water inside the drum has been drained before opening its door. Please do not open the door if there is any water visible.
- Be careful of scalding when the product drains hot washing water.
- After the program is completed, please wait for two minutes to open the door.
- Never refill the water by hand during washing.

SAFETY INSTRUCTIONS

- Fabric softeners, or similar products, should be used as specified by the fabric softener instructions.
- The final part of a wash cycle occurs without heat (cool down cycle) to ensure that the items are left at a temperature that ensures that the items will not be damaged.
- Remove all objects from pockets such as lighters and matches before using the appliance.

Packaging/Old appliance



This marking indicates that this product should not be disposed with other household wastes throughout the EU. To prevent possible harm to the environment or human health from uncontrolled waste disposal, recycle it responsibly to promote the sustainable reuse of material resources. To return your used device, please use the collection systems or contact the retailer where the product was purchased. They return and can take this product for environmental safe recycling.

INSTALLATION

■ Product Description

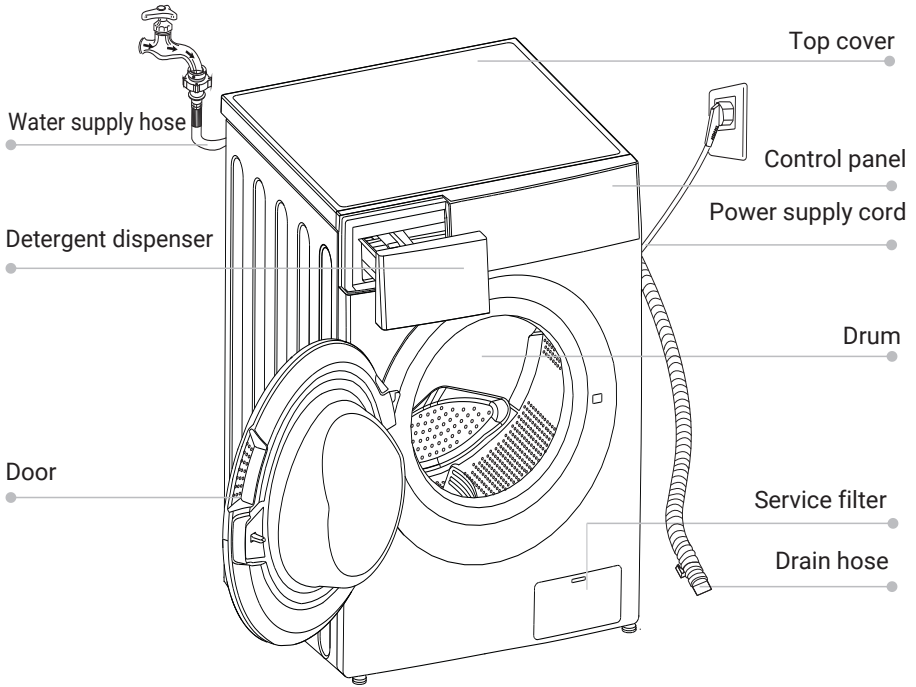

📌 Note!

- The product line chart is for reference only, please refer to real product as standard.

Accessories

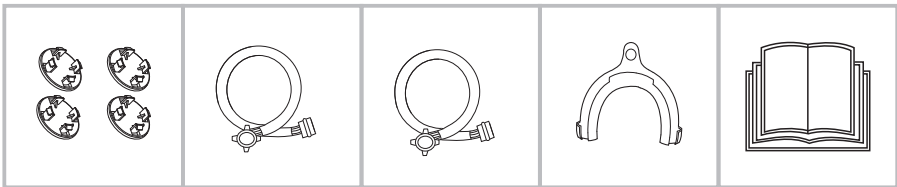

Transport hole plug

Supply hose cold water

Supply hose hot water (optional)

Drain hoses support (optional)

Owner's manual

INSTALLATION

■ Installation

Installation area

⚠ Warning!

- Stability is important to prevent the product from wandering!
- Make sure that the product does not stand on the power cord.

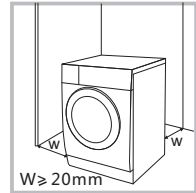

The installation site must satisfy the following criteria:

1. Rigid, dry, and level surface
2. Avoid direct sunlight
3. Sufficient ventilation
4. Room temperature is above 0°C
5. Keep far away from the heat sources.

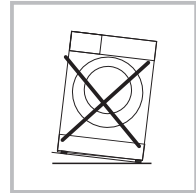

Unpacking the washing machine

⚠ Warning!

- Packaging material (e.g. Films, Styrofoam) can be dangerous for children.
- There is a risk of suffocation! Keep all packaging well away from children.

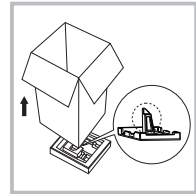

1. Remove the cardboard box and styrofoam packing.
2. Lift the washer dryer and remove the base packing. Make sure the small foam triangle is removed with the bottom. If not, lay the unit down with side surface, then remove the small foam from the unit bottom manually.
3. Remove the tape securing the power supply cord and drain hose.
4. Remove the inlet hose from the drum.

Remove transport bolts

⚠ Warning!

- You must remove the transport bolts from the rear before using the product.
- You'll need the transport bolts again if you move the product, so make sure you keep them in a safe place.

Please take the following steps to remove the bolts:

1. Loosen 4 bolts with a spanner and then remove them.
2. Stop the holes with transport hole plugs.
3. Keep the transport bolts safe for future use.

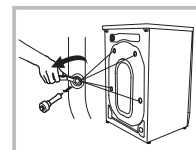

INSTALLATION

Levelling the washer dryer

⚠ Warning!

- The lock nuts on all four feet must be screwed tightly against the housing.

1. Check if the legs are attached to the cabinet. If not, please turn them to their original positions tighten the nuts.
2. Loosen the lock nut turn the feet until it closely contacts with the floor.
3. Adjust the legs and lock them with a spanner, make sure the machine is steady.

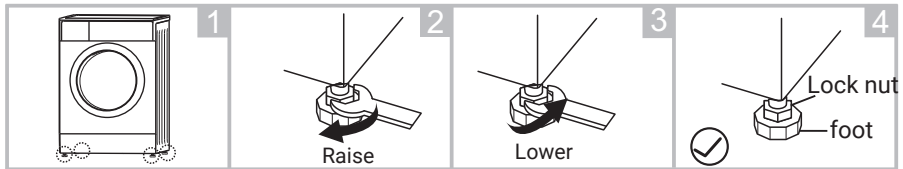

Connect Water Supply Hose

⚠ Warning!

- To prevent leakage or water damage, follow the instructions in this chapter.
- Do not kink, crush, modify or sever the water inlet hose.

Connect the inlet pipe as indicated, there are two ways to connect the inlet pipe.

1. Connection between ordinary tap and inlet hose.

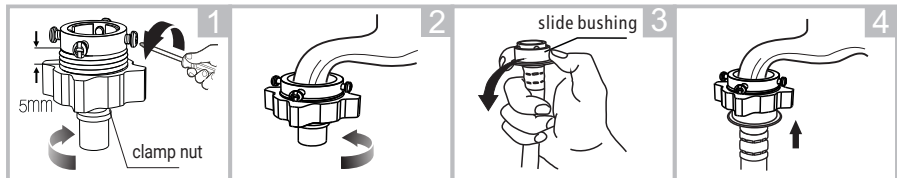

Loosen clamp nut and four bolts

Tighten clamp nut

Press slide bushing, Connection complete. insert inlet hose into connecting base

2. Connection between screw tap and inlet hose.

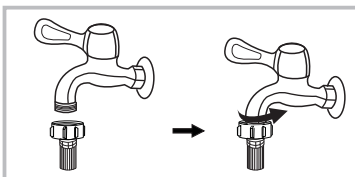

Tap with threads and inlet hose

INSTALLATION

Connect the other end of inlet pipe to the inlet valve at the rear of product and fasten the pipe tightly clockwise.

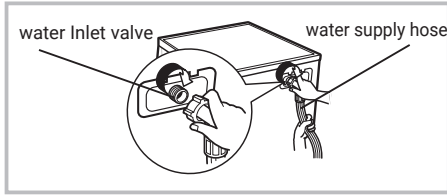

Drain Hose

⚠ Warning!

- Do not kink or protract the drain hose.
- Position drain hose properly, to avoid water leakage.

There are two ways to place the end of drain hose:

1. Put it into the water trough.

2. Connect it to the branch drain pipe of the trough.

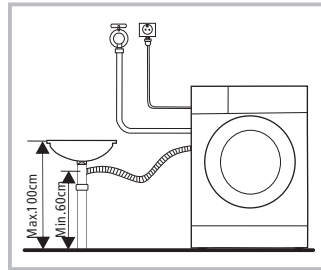
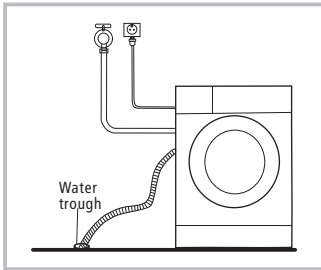

📌 Note!

- If the machine has drain hose support, please install it like the following .

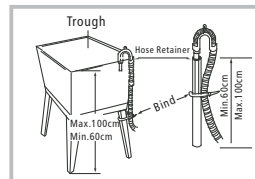
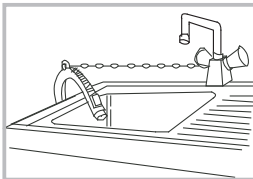

⚠ Warning!

- When installing drain hose, fix it properly with a rope.
If drain hose is too long, do not force it into washing machine as it will cause abnormal noises.

OPERATIONS

■ Quick Start

⚠ Caution!

- Before washing, please make sure it is installed properly.
- Before washing for first time, the washing machine should be operated for one cycle without clothes in as follows.

🔧 Calibration

It's recommend to calibrate the machine prior to use.

- 1- Ensure the washing machine is empty and installed as per previous instruction.
- 2- Plug in;
- 3- Power on the machine and press "Temp." and "Soil" at the same time within 10 seconds then display "t19"
- 4- Press to ▷|| start the machine and wait till display shows "****"

1. Before Washing

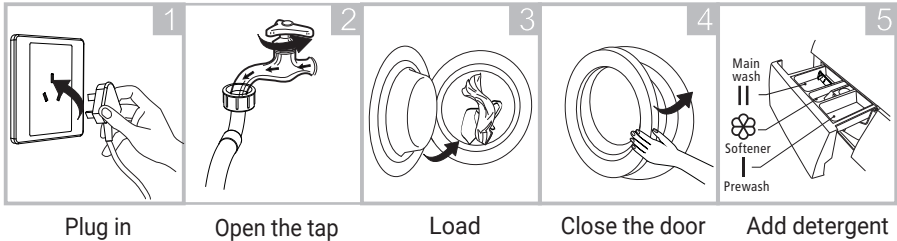

🔧 Note!

- Detergent needs to be added in "case I " if selecting pre-washing.

2. Washing

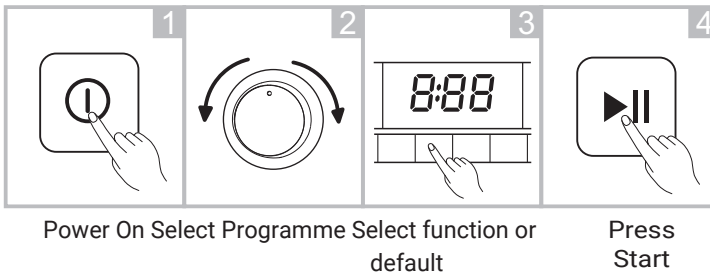

OPERATIONS

Note!

- 1. If default is selected, step 3 can be skipped.
- 2. The function button line chart is for reference only, please refer to real product as standard.

3. After Washing

Buzzer beep or "End" on display.

■ Before Each Washing

- The working condition of the washer should be (0-40)°C. If used under 0°C, the inlet valve and draining system may be damaged. If the machine is placed under condition of 0°C or less, then it should be transferred to normal ambient temperature to ensure the water supply hose and drain hose are not frozen before use.
- Please check the labels and the detergent instructions prior to use. Use non-foaming or reduced-foaming detergent suitable for machine washing properly.

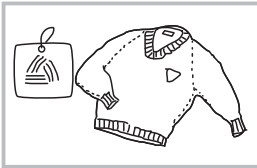

Check the label



Take any items out of the pockets

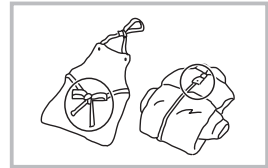

Knot long strings, fasten zips or buttons.

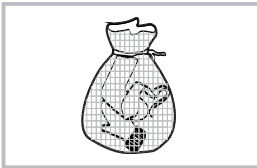

Put small clothes into a net bag

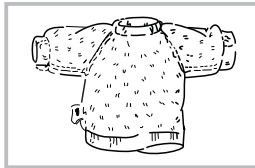

Turn easy-pilling and long-pile fabric inside out

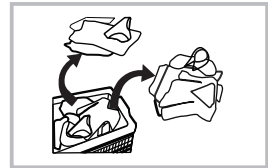

Separate clothes with different textures

⚠ Warning!

- When washing a single item, it may easily cause balancing problems. Therefore it is suggested to add one or two more clothes to be washed together so that draining can be done smoothly.
- Do not wash clothes soiled with kerosene, gasoline, alcohol and other flammable materials.

OPERATIONS

■ Detergent Dispenser

- I Pre wash detergent
- II Main wash detergent
- ☼ Softener

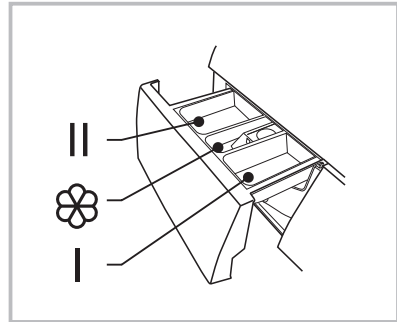

Pull out the dispenser

⚠ Caution!

- Detergent only needs to be added in "case I" after selecting pre-washing for machines with this function.

Programme	I	II / △	☼	Programme	I	II / △	☼
Cotton	○	●	○	Rinse & Spin			○
Synthetic	○	●	○	Wool		●	○
Mix	○	●	○	ECO 40-60		●	○
Bed Linen	○	●	○	Intensive		●	○
Baby Care	○	●	○	Quick 15'		●	○
20°C		●	○	Dry Only			
Drum Clean				1h W/D		●	○
Spin Only				Wash and Dry		●	○

- Required
- Optional

📌 Note!

- For the agglomerated detergent or additive, before they are poured into the detergent box, it is suggested to use some water for dilution to prevent the inlet of detergent box from being blocked and overflowing while filling water.
- Please choose a suitable type of detergent for the various washing temperature to get the best washing performance with less water and energy consumption.

OPERATIONS

Control Panel

Model: CK8512

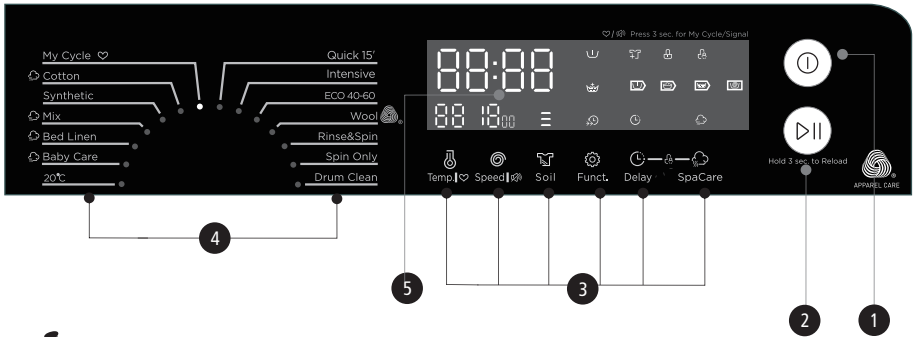

Note!

- The chart is for reference only, Please refer to real product as standard.

1 On/Off

Product is switched On/Off.

2 Start/Pause

Press the button to start or pause the washing cycle.

3 Option

This allows you to select an additional function and will light when selected.

4 Programmes

Available according to the laundry type.

5 Display

The display shows the settings, estimated time remaining, options, and status messages for your washer. The display will remain on through the cycle.

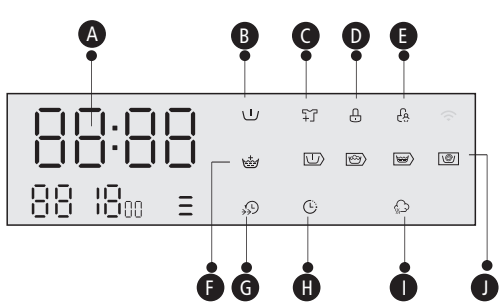

A Display

Wash Time	Delay Time
125	2h
Speed	Error
400	1 3U
End	Temp.
End	30

B Pre Wash C Reload

D Door Lock E Child Lock

F Extra Rinse G Speed Wash

H Delay I SpaCare

J Pre Wash-Wash-Rinse-Spin

OPERATIONS

■ Option

Delay

Delay

Set the Delay function:

1. Select a programme; 2. Press the Delay button to choose the time (the delaying time is 0-24 H.); 3. Press [Start/Pause] to commence the delay operation



Choose the Programme

Setting time

Start

Cancel the Delay function:

Press the [Delay] button until the display shows 0H. It should be pressed before starting the programme. If the programme has already started, switch off the programme to reset a new one.

Soil Level

Soil

The washing time will increase or decrease when you select it.

⚠ Caution!

- If there is any break in the power supply while the machine is operating, the memory stores the selected programme and when the power is restarted, the program will continue.

Pre Wash

Pre Wash

The Prewash function can get an extra wash before main wash. You need to put detergent into the Case (I) when selected.

Extra Rinse

Extra Rinse

The laundry will undergo an extra rinse when selected.

Speed Wash

Speed Wash

The function can decrease the washing time.



My Cycle

To memorise your most frequently used programme.

After choosing the programme and setting the desired options, hold down [Temp.] for 3 seconds before starting the wash. The default setting is Cotton.

OPERATIONS



Reload

This operation can be executed during the washing progress. When the drum is still rolling and there is large amount of water with high temperature in the drum. The state is unsafe and the door cannot be opened forcefully. To press [Start/Pause] for 3 sec. to add clothes mid cycle.

1. Wait until the drum stops rotation.
2. The door lock is unlocked.
3. Close the door when the clothes are reloaded and press the [Start/Pause] button.



Press[Start/Pause]3sec.



Reload the clothes



Start

SpaCare

SpaCare

SpaCare function can be selected by choosing "Cotton", "Mix" "Bed Linen" and "Baby Care".

You can see the steam in the drum when you operate SpaCare function. The SpaCare cannot be used simultaneously With Pre Wash and Speed Wash.

⚠ Caution!

- Don't use the Reload function when the water level is over the edge of the inner tub or the temperature is high.

OPERATIONS

■ Other Functions

Temp.

Temp.

Press the button to set the wash temperature(Cold,20°C, 30°C, 40°C, 60°C, 90°C)

Speed

Speed

Press the button to change the speed.

0-400-600-800-1000-1200-1400

Model: CK8512

Programme	Default Speed(rpm)	Programme	Default Speed(rpm)
	1400		1400
Cotton	1400	Spin Only	1000
Synthetic	1200	Rinse & Spin	1000
Mix	800	Wool	600
Bed Linen	1000	ECO 40-60	1400
Baby Care	800	Intensive	800
20°C	1000	Quick 15'	800
Drum Clean	-		

OPERATIONS



Child Lock

To avoid mis operation by children.



Press [Delay] and [SpaCare] for 3 sec. until buzzer beeps.

⚠ Caution!

When child lock is activated and program starts, child lock indicator will switch on, and the CL and remaining time on the display are alternately displayed in 0.5s. Press the other buttons will make child lock indicator flash for 3s. when the cycle finishes, CL and END alternate for 10s in 0.5s, then the child lock lights flash for 3s.

- Press and hold the two buttons again to release child lock.
- The "Child Lock" will lock all buttons except the Power button and Child Lock button.
- Please release child lock before selecting program and starting washing.



Mute the buzzer



Choose the Programme



Press the [Speed]button for 3sec., the buzzer will mute.

To activate the buzzer function, press the button again for 3 seconds. The setting will be kept until the next reset.

⚠ Caution!

- After Muting the buzzer function, notifications will not be heard any more.

OPERATIONS

■ Programmes

Programmes are available according to the laundry type.

Programmes	
Cotton	Hard-wearing textiles, heat-resistant textiles made of cotton or linen.
Synthetic	Wash synthetic articles, for example: shirts & coats. While washing the knitted textiles, detergent quantity should be reduced due to its loose string construction and additional foaming properties.
Baby Care	Washing the baby's clothes, it can make the baby's wear cleaner and make the rinse performance better to protect the baby skin.
Mix	Mixed load consisting of textiles made of cotton and synthetics.
Bed Linen	This program is specially designed for washing bed linen
20°C	20°C default, can choose cold water.
ECO 40-60	Default 40°C, not selectable, suitable for laundry washing at about 40°C- 60°C.
Quick 15'	Extra short programme, suitable for small quantities of lightly soiled washing. For small synthetic clothes or shirts, load limitation is 1 kg (about 4 shirts).
Quick 15'	
1h W/D	
Wool	Hand or machine-washable wool or richwool textiles. Especially gentle wash programme to prevent shrinkage, longer programme pauses (textiles rest in wash water).
Spin Only	Extra spin with selectable spin speed.
Rinse & Spin	Extra rinse with spin.
Intensive	To increase the washing performance, washing time is increased.
Drum Clean	To clean the drum and tube. It applies 90 °C high temperature sterilization. When this programme is performed, the clothes or other washing cannot be added. When proper amount of chlorine bleaching agent is put in, the barrel cleaning effect will be better. You can use this programme regularly according to your requirements.

OPERATIONS

■ Washing Programmes Table

Model: CK8512

Programme	Load (kg)					Temp.(°C)	Default Time
	7.0	8.0	9.0	10.0	12.0		
	7.0	8.0	9.0	10.0	12.0	Default	7.0/8.0/9.0/10.0/12.0
Cotton	7.0	8.0	9.0	10.0	12.0	40	3:39
Synthetic	3.5	4.0	4.5	5.0	6.0	40	3:18
Mix	7.0	8.0	9.0	10.0	12.0	40	1:20
Bed Linen	7.0	8.0	9.0	10.0	12.0	40	1:48
Baby Care	7.0	8.0	9.0	10.0	12.0	60	1:42
20	7.0	8.0	9.0	10.0	12.0	20	1:01
Drum Clean	-	-	-	-	-	90	1:18
Spin Only	7.0	8.0	9.0	10.0	12.0	-	0:12
Rinse&Spin	7.0	8.0	9.0	10.0	12.0	-	0:20
Wool	2.0	2.0	2.0	2.0	2.0	40	1:07
ECO 40-60	7.0	8.0	9.0	10.0	12.0	-	3:13/3:32/3:41/3:35/3:53/3:56
Intensive	7.0	8.0	9.0	10.0	12.0	40	3:48
Quick 15'	2.0	2.0	2.0	2.0	2.0	Cold	0:15

- Concerning to Regulation(EU) No 1061/2010,
The EU energy efficiency class is: A+++
Energy test program: Intensive 60/40 °C; Speed:The highest speed; Other as the default.
Half load for 7.0/8.0/9.0/10.0/12.0Kg machine:3.5/4.0/4.5/5.0/6.0Kg.
- Concerning to Regulation(EU) 2019/2023,
The EU energy efficiency class is: B
Energy test program: ECO 40-60. Other as the default.
Half load for 7.0/8.0/9.0/10.0/12.0Kg machine:3.5/4.0/4.5/5.0/6.0Kg.
Quarter load for 7.0/8.0/9.0/10.0/12.0Kg machine:2.0/2.0/2.5/2.5/3.0Kg.

Note!

- The parameters in this table are only for user's reference. The actual parameters may be different with the parameters in above mentioned table.

MAINTENANCE

■ Cleaning And Care

⚠ Warning!

- Before your maintenance starts, please unplug the machine and close the tap.

Cleaning The Cabinet

Proper maintenance of the washing machine can extend its working life. The surface can be cleaned with diluted non-abrasive neutral detergents when necessary. If there is any water overflow, use a wet cloth to wipe it off immediately. No sharp items are allowed.

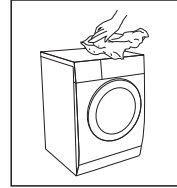

📌 Note!

- Formic acid and its diluted solvents or equivalent are forbidden, such as alcohol, solvents or chemical products, etc.

Cleaning The Drum

The rusts left inside the drum by the metal articles shall be removed immediately with chlorine-free detergents. Never use steel wool.

📌 Note!

- Don't put laundry in the washing machine during drum cleaning.

Cleaning The Door Seal And Glass

Wipe the glass and seal after each wash to remove lint and stains. If lint builds up it can cause leaks.

Remove any coins, buttons and other objects from the seal after each wash.

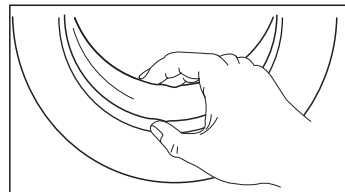

MAINTENANCE

Cleaning The Inlet Filter

Note!

- Inlet filter must be cleaned if there is less water.

Washing the filter in the tap

1. Close the tap.
2. Remove the water supply hose from the tap.
3. Clean the filter.
4. Reconnect the water supply hose.

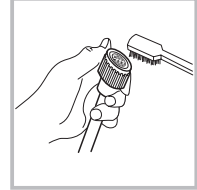
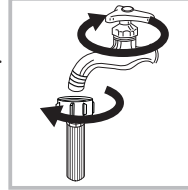

Washing the filter in washing machine:

1. Unscrew the inlet pipe from the backside of the machine.
2. Pull out the filter with long nose pliers and reinstall it back after being washed.
3. Use a brush to clean the filter.
4. Reconnect the inlet pipe.

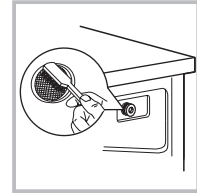
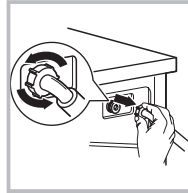

Note!

- If the brush is not clean, you can pull out the filter and wash separately.
- Reconnect, turn on the tap.

Clean The Detergent Dispenser

1. Press down the arrow located on the softener cover inside the dispenser drawer.
2. Lift the clip up and take out softener cover and wash thoroughly with water.
3. Restore the softener cover and push the drawer into position.

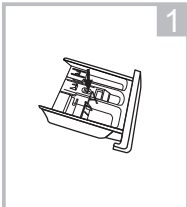

Pull out the dispenser drawer by pressing the

Arrow



Clean the dispenser drawer under water

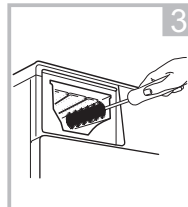

Clean inside the recess with an old toothbrush

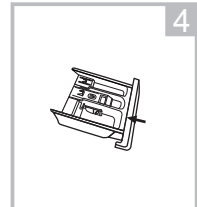

Insert the dispenser drawer

Note!

- Do not use alcohol, solvents or chemical products to clean the machine.

MAINTENANCE

Cleaning The Drain Pump Filter

⚠ Warning!

- Be careful of hot water!
- Allow detergent solution to cool down.
- Unplug the machine to avoid electrical shock before cleaning.
- Drain pump filter can become blocked with yarns and small foreign matters.
- Clean the filter periodically to ensure the normal operation of washing machine.

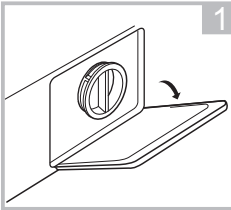

Open the lower cover cap

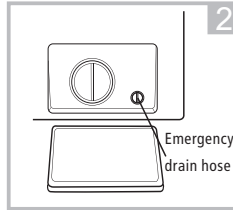

Rotate 90° and pull out the emergency drain hose, and take off the hose cap

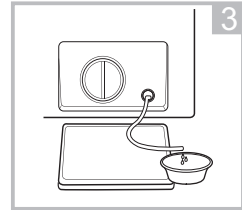

After water runs out, reset the drain hose



Open the filter by turning to the counter clockwise

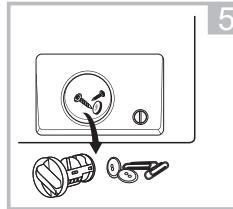

Remove extraneous matter

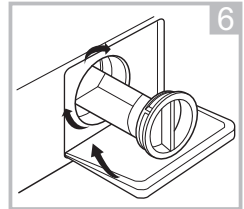

Close the lower cover cap

⚠ Caution!

- Make sure that valve cap and emergency drain hose are reinstalled properly, cap plates should be inserted aligning to hole plates otherwise water may leak.
- Some machines don't have emergency drain hose, so step 2 and step 3 can be skipped. Rotate lower cover cap directly to make water run into basin.
- When the appliance is in use and depending on the programme selected there can be hot water in the pump. Never remove the pump cover during a wash cycle, always wait until the appliance has finished the cycle, and is empty. When replacing the cover, ensure it is securely re-tightened.

MAINTENANCE

■ Trouble Shooting

In the event that the appliance does not work or if it stops during operation. First try to find a solution to the problem, using the table below. If not, contact the service centre.

Description	Reason	Solution
Washer cannot start up	Door is not closed properly	Restart after the door is closed Check if clothes are stuck
Door can't be opened	Washer's safety protection design is working	Disconnect the power, restart the product
Water leakage	The connection between inlet pipe or outlet hose is not tight	Check and fasten water pipes Clean up outlet hose
Detergent residues in the box	Detergent is dampened or agglomerated	Clean and wipe the detergent box
Indicator or display does not light	No power PC board or harness has connection problem	Check for power cut and the power plug is connected correctly
Abnormal noise		Check if the fixing (bolts) have been removed Check it's installed on a solid and level floor

Description	Reason	Solution
E30	Door is not closed properly	Restart after the door is closed Check if clothes is stuck
E10	Water injecting problem while washing	Check if the water pressure is too low Straighten the water pipe Check if the inlet valve filter is blocked.
E21	Extended draining duration	Check if the drain hose is blocked
E12	Water overflow	Restart the washer
EXX	Others	Power cycle and call service line if problem persists

Note!

- After checking, activate the appliance. If the problem occurs or the display shows other alarm codes again, contact service.

MAINTENANCE

■ Technical Specifications

Power Supply 220-240V~,50Hz

MAX.Current 10A

Standard Water Pressure 0.05MPa~1MPa

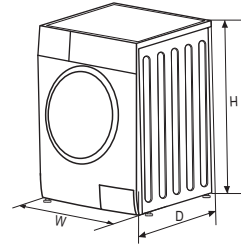

Model	Washing Capacity	Dimension (W*D*Hmm)	Net Weight	Rated Power
CK8512	12.0kg	595*595*850	73kg	2000W

MAINTENANCES

Supplier's name or trade mark: Cater-Wash

Supplier's address: The Lakeland Catering Centre, Newland, Ulverston, Cumbria. LA12 7QQ

Model identifier: CK8512

Parameter	Value		Parameter	Value	
Rated capacity ^(*) (kg)	12.0		Dimensions in cm	Height	85
				Width	60
				Depth	60
EEI _w ^(*)	60.0		Energy efficiency class ^(*)	B	
Washing efficiency index ^(*)	1.04		Rinsing effectiveness (g/kg) ^(*)	5.0	
Energy consumption in kWh per cycle, based on the eco 40-60 programme. Actual energy consumption will depend on how the appliance is used.	0.628		Water consumption in litre per cycle, based on the eco 40-60 programme. Actual water consumption will depend on how the appliance is used and on the hardness of the water.	57	
Maximum temperature inside the treated textile ^(*) (°C)	Rated capacity	40	Remaining moisture content ^(*) (%)	Rated capacity	53
	Half	38		Half	53
	Quarter	20		Quarter	53
Spin speed ^(*) (rpm)	Rated capacity	1400	Spin-drying efficiency class ^(*)	B	
	Half	1400			
	Quarter	1400			
Programme duration ^(*) (h:min)	Rated capacity	4 : 00	Type	free-standing	
	Half	3 : 00			
	Quarter	3 : 00			
Airborne acoustical noise emissions in the spinning phase ^(*) (dB(A) re 1 pW)	80		Airborne acoustical noise emission class ^(*) (spinning phase)	C	
Off-mode (W)	0.50		Standby mode (W)	N/A	
Delay start (W) (if applicable)	4.00		Networked standby (W) (if applicable)	N/A	

Minimum duration of the guarantee offered by the supplier ^(*):

This product has been designed to release silver ions during the washing cycle

NO

Additional information:

^(*) for the eco 40-60 programme.

^(*) changes to these items shall not be considered relevant for the purposes of paragraph 4 of Article 4 of Regulation (EU) 2017/1369.

^(*) if the product database automatically generates the definitive content of this cell the supplier shall not enter these data.

MAINTENANCES

Note!

- Programme setting for testing in accordance with applicable standard En60456 for wash.
- Programme setting for testing in accordance with applicable standard En50229 for wash and dry.
- When using the test programmes, wash the specified load using the maximum spin speed.
- The actual parameters will depend on how the appliance is used, and may be different with the parameters in above mentioned table.
- The household washing machine is equipped with power management system. The duration of the left-on mode time is less than 10 minute.
- The noise emissions during washing/spinning for the standard washing cycle at full load.

Remarks:

- ① The energy efficiency class is from A(highest efficiency) to D (lowest efficiency)
- ② Energy consumption per year, based on 220 standard washing cycles for standard programme at 60°C and 40°C at full and partial load, and the consumption of the low-power modes. Actual energy consumption will depend on how the appliance is used.
- ③ Water consumption per year based on 220 standard washing cycles for standard programme at 60°C and 40°C at full and partial load. Actual water consumption will depend on how the appliance is used.
- ④ Spin-drying efficiency class from G (least efficient) to A (most efficient).
- ⑤ The standard 60°C programme and the standard 40°C programme are the standard washing programmes. These programmes are suitable to clean normally soiled cotton laundry and they are the most efficient programmes in terms of combined energy and water consumptions for washing that type of cotton laundry. The actual water temperature may differ from the declared cycle emperature.
Please choose the suitable type of detergent for the various washing temperatures to get the best washing performance with less water and energy consumption.