



5702150



SALES DESCRIPTION

- For Sammic rack conveyor dishwashers.
 Specially designed to suit each user's specific needs.
- ✓ Roller units with free turn and tank.
 - ✓ In 90°, possibility of coupling to 180°.
 - ✓ Hinged models available, to fit 180° machined curves.

SPECIFICATIONS

Crated dimensions
 800 x 800 x 400 mm
 Gross weight: 38 Kg





CR-90 90° CURVE WITH FEET



5702150

WARE WASHING
RACK CONVEYOR DISHWASHERS

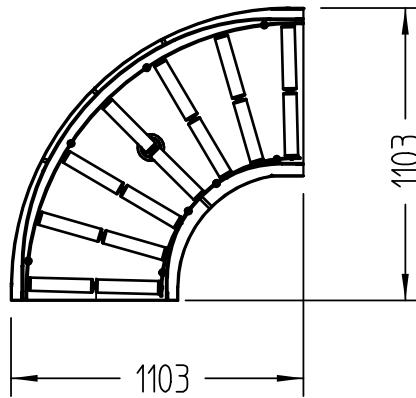
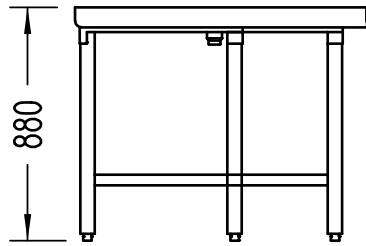

www.sammic.co.uk
Food Service Equipment Manufacturer
Unit 2, Trevanth Road
Troon Industrial Park
LE4 9LS - Leicester
uksales@sammic.com
Tel.: +44 0116 246 1900



Project	Date
Item	Qty
Approved	

product sheet
updated 03/08/2022