



**Electrolux**

## Modular Cooking Range Line 700XP One Well Freestanding Electric Fryer 15 liter

ITEM # \_\_\_\_\_

MODEL # \_\_\_\_\_

NAME # \_\_\_\_\_

SIS # \_\_\_\_\_

AIA # \_\_\_\_\_



**Electrolux**



Modular Cooking Range Line

700XP One Well Freestanding Electric  
Fryer 15 liter

**371081 (E7FRED1GF0)**

700XP ONE 15 LT WELL  
FREESTANDING ELECTRIC  
FRYER - 400 V

### Short Form Specification

#### Item No. \_\_\_\_\_

To be installed on height adjustable feet in stainless steel. High efficiency infrared heating elements (10kW) attached to the outside of the well. Deep drawn V-shaped well. Oil drains through a tap into a container under the well. Exterior panels in stainless steel with Scotch Brite finish. One piece pressed work top in 1.5 mm thick stainless steel. Right-angled side edges to allow flush-fitting junction between units.

### Main Features

- Unit to be mounted on height adjustable feet in stainless steel.
- Deep drawn V-Shaped well.
- High efficiency infrared heating elements are attached to the outside of the well.
- Thermostatic regulation of oil temperature up to a maximum of 185 °C.
- Overheat protection thermostat as standard on all units.
- Oil drains through a tap into a drainage container positioned under the well.
- All major compartments located in front of unit for ease of maintenance.
- IPX 4 water protection.

### Construction

- Interior of well with rounded corners for ease of cleaning.
- All exterior panels in Stainless Steel with Scotch Brite finishing.
- One piece pressed 1.5 mm work top in Stainless steel.
- Model has right-angled side edges to allow flush fitting joints between units, eliminating gaps and possible dirt traps.

### Included Accessories

- 1 of Door for open base cupboard PNC 206350
- 1 of Full size basket for 14 and 15lt free standing fryers PNC 921691

### Optional Accessories

- 4 wheels, 2 swivelling with brake (700/900XP). It is mandatory to install with base supports for feet/wheels. PNC 206135 ☐
- Flanged feet kit PNC 206136 ☐
- Frontal kicking strip for concrete installation, 200mm PNC 206146 ☐
- Frontal kicking strip for concrete installation, 400mm PNC 206147 ☐
- Frontal kicking strip for concrete installation, 800mm PNC 206148 ☐
- Frontal kicking strip for concrete installation, 1000mm PNC 206150 ☐
- Frontal kicking strip for concrete installation, 1200mm PNC 206151 ☐
- Frontal kicking strip for concrete installation, 1600mm PNC 206152 ☐
- Frontal kicking strip, 200mm (not for refr-freezer base) PNC 206174 ☐

APPROVAL: \_\_\_\_\_



**Electrolux**

## Modular Cooking Range Line 700XP One Well Freestanding Electric Fryer 15 liter

- Frontal kicking strip, 400mm (not for refr- freezer base) PNC 206175 ☐
- Frontal kicking strip, 800mm (not for refr- freezer base) PNC 206176 ☐
- Frontal kicking strip, 1000mm (not for refr- freezer base) PNC 206177 ☐
- Frontal kicking strip, 1200mm (not for refr- freezer base) PNC 206178 ☐
- Frontal kicking strip, 1600mm (not for refr- freezer base) PNC 206179 ☐
- 4 feet for concrete installation PNC 206210 ☐
- Sediment tray for 15lt fryers PNC 206235 ☐
- Pair of side kicking strips PNC 206249 ☐
- Pair of side kicking strips for concrete installation PNC 206265 ☐
- Oil drain pipe for 15lt free standing fryer PNC 206301 ☐
- Chimney upstand, 400mm PNC 206303 ☐
- Right and left side handrails PNC 206307 ☐
- Door for open base cupboard PNC 206350 ☐
- Base support for feet or wheels - 400mm (700/900XP) PNC 206366 ☐
- Base support for feet or wheels - 800mm (700/900) PNC 206367 ☐
- Base support for feet or wheels - 1200mm (700/900) PNC 206368 ☐
- Base support for feet or wheels - 1600mm (700/900) PNC 206369 ☐
- Base support for feet or wheels - 2000mm (700/900) PNC 206370 ☐
- Rear paneling - 600mm (700/900XP) PNC 206373 ☐
- Rear paneling - 800mm (700/900) PNC 206374 ☐
- Rear paneling - 1000mm (700/900) PNC 206375 ☐
- Rear paneling - 1200mm (700/900) PNC 206376 ☐
- Chimney grid net, 400mm PNC 206400 ☐
- 2 side covering panels, h=700mm, d=700mm PNC 216000 ☐
- Frontal handrail 400mm PNC 216046 ☐
- Frontal handrail 800mm PNC 216047 ☐
- Frontal handrail 1200mm PNC 216049 ☐
- Frontal handrail 1600mm PNC 216050 ☐
- Large handrail - portioning shelf, 400mm PNC 216185 ☐
- Large handrail - portioning shelf, 800mm PNC 216186 ☐
- Full size basket for 14 and 15lt free standing fryers PNC 921691 ☐
- 2 half size baskets for 12, 14 and 15lt fryers PNC 921692 ☐
- Filter for fryer oil collection basin for 7lt, 14lt, 15lt free standing fryers PNC 921693 ☐
- Unclogging rod for 15lt drainage pipe PNC 921695 ☐
- Deflector for floured products for 15lt fryers PNC 921696 ☐



**Modular Cooking Range Line  
700XP One Well Freestanding Electric Fryer 15 liter**

The company reserves the right to make modifications to the products without prior notice. All information correct at time of printing.

2014.06.23



**Electrolux**

## Modular Cooking Range Line 700XP One Well Freestanding Electric Fryer 15 liter

Front

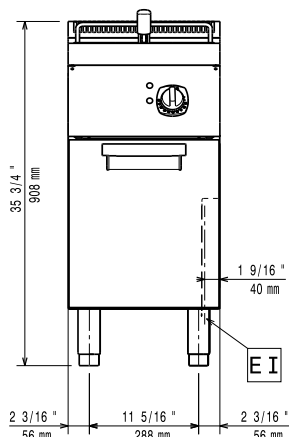

Top

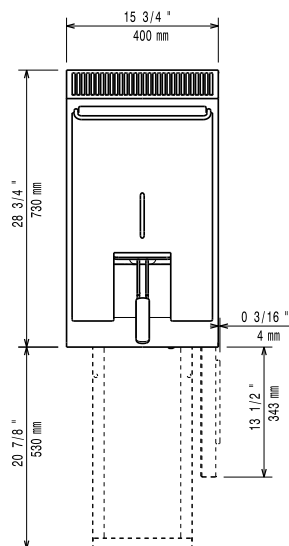

**EI** = Electrical connection

Side

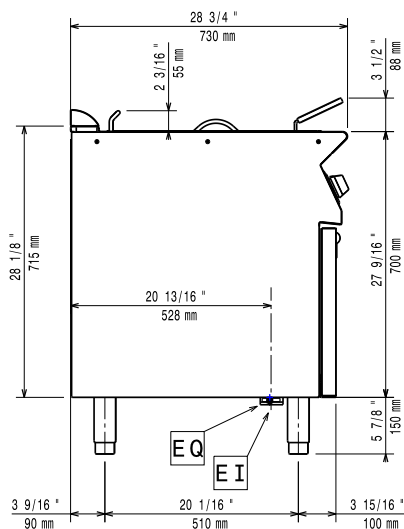

### Electric

#### Supply voltage:

**371081 (E7FRED1GF0)**

400 V/3N ph/50/60 Hz

#### Total Watts:

10 kW

### Key Information

**Usable well dimensions (width):** 240 mm

**Usable well dimensions (height):** 505 mm

**Usable well dimensions (depth):** 380 mm

**Well capacity:** 13 lt MIN; 15 lt MAX

**Thermostat Range:** 105 °C MIN; 185 °C MAX

**Net weight:** 55 kg

**Shipping weight:** 64 kg

**Shipping height:** 1140 mm

**Shipping width:** 460 mm

**Shipping depth:** 820 mm

**Shipping volume:** 0.43 m<sup>3</sup>

If appliance is set up or next to or against temperature sensitive furniture or similar, a safety gap of approximately 150 mm should be maintained or some form of heat insulation fitted.



**Modular Cooking Range Line  
700XP One Well Freestanding Electric Fryer 15 liter**

The company reserves the right to make modifications to the products without prior notice. All information correct at time of printing.

2014.06.23