

CAFÉ ELITE

USER MANUAL



UM_EN

Part No.: 1730066_04



CONTENT	2
GENERAL.....	4
Introduction	4
Warnings.....	4
Precautions.....	4
Intended use.....	4
Facts & weight.....	5
OVERVIEW OF COMPONENTS.....	6
Front exterior.....	6
Front interior of Elite II	7
Front interior of Elite III	8
Front interior of Elite IV.....	9
Membrane switch navigation	10
Technical service card	11
INSTALLATION AND START-UP.....	12
Positioning.....	12
Machine startup procedure	12
Fill ingredient canisters	13
OPERATION	14
Dispensing drinks in a cup	14
Dispensing drinks in a jug.....	15
CLEANING PROGRAM.....	16
Automatic rinsing of the mixing bowl.....	16
Automatic cleaning of dispenser valves	17
CLEANING AND CARE.....	18
Disassemble mixing system	18
Wash these parts	19
Reassemble mixing system	19
Failure message.....	20
Storage / Transport.....	20
Exterior cleaning	21
MESSAGE SHOWN ON DISPLAY.....	22
PROGRAMMING	23
Activate programming with smart card.....	23
Buttons function.....	23
Main menu	24

Clean machine 24

Counters 25

DIMENSION SKETCH 27

Café Elite 27

Some important information may appear in textboxes seen below

 IMPORTANT! INFO.	 CAUTION! INFO.	More INFO.	Note INFO.
---	--	------------	------------

Introduction

Thank you for choosing a Café Elite vending machine.

We hope you enjoy it !

- Read the user guide before using the machine.
- This guide contains important instructions for proper and safe use of the vending machine.
- Always keep this guide close at hand for future reference.

Warnings

- Never immerse the machine, plug or mains cable in water because there is a danger of electric shock.
- The appliance is not intended for use by persons (including children) with reduced physical, sensory or mental capabilities, or lack of experience and knowledge, unless they have been given supervision or instruction concerning the use of the appliance by a person responsible for their safety.
- Children should be supervised to ensure they do not play with the appliance.
- Do not use the machine if the mains cable, plug is damaged or the machine has fallen down.
- If the mains cable is damaged it must be replaced by the manufacturer, service agent or similarly qualified persons in order to avoid a hazard.
- Only plug the machine into a properly installed earthed safety socket whose line voltage matches the technical data for the machine.

Precautions

- Do not use the machine outdoors so it can be exposed to weather (rain, snow, frost). It will cause material damage to the machine.
- Do not try to open the machine or repair it in any way. To avoid danger only have the machine repaired in a technical workshop, Service Centre or by a qualified person.
- Remove the mains cable from the socket when the machine is not in use for longer periods. To do this, pull the plug not the cable.
- This appliance must be placed in a horizontal position which is resistant to any water that may leak.
- Place the machine out of the reach of children.
- Position the mains cable so that people cannot trip over it. Keep it away from sharp edges and heat sources.
- The new hose-sets supplied with this appliance are to be used, old hose-sets must not be re-used.
- This appliance is not suitable for installation in an area where a water jet could be used.
- This appliance must not be cleaned by a water jet.

Intended use

- This appliance is intended to be used in household and similar applications such as:
 - Staff kitchen areas in shops.
 - Offices and other commercial working environments.
 - On agricultural estates.
 - By clients in hotels, motels and other residential type environments.
 - Bed and breakfast type environments.
- For the optimal performance of the machine these parameters shall not be exceeded:
 - Maximum permissible inlet water pressure : 800KPa (8Bar)
 - Minimum permissible inlet water pressure: 200KPa (2Bar)
 - Maximum working temperature: 40 °C
 - Minimum working temperature: 10 °C

Facts & weight

MODEL/NAME	CAFÉ ELITE II	CAFÉ ELITE III	CAFÉ ELITE IV
Built-in grinder	None	None	None
Function for selecting jug	Yes	Yes	Yes
Drink options	5	8	8
Ingredient canister	2	3	4
Bean hopper	None	None	None
Brewing mechanism	None	None	None
Cleaning function by smart card	Yes	Yes	Yes
Electronic temperature control	Yes	Yes	Yes
Adjustable coffee strength	Yes	Yes	Yes
Illumination of cup during brewing	None	None	None
Base cabinet: large grounds container	None	None	None
Energy saving mode	Yes	Yes	Yes
Height, Width, Depth	735, 310, 515mm	735, 310, 515mm	735, 310, 515mm
Tank volume	5Litres	5Litres	5Litres
Power supply	220-230VAC 50/60Hz/2200W	220-230VAC 50/60Hz/2200W	220-230VAC 50/60Hz/2200W
Cold water connection	½" External thread	½" External thread	½" External thread
Water purification filter	None	None	None

MODEL/NAME	WEIGHT
Café Elite II	30kg
Café Elite III	30kg
Café Elite IV	30kg

Front exterior

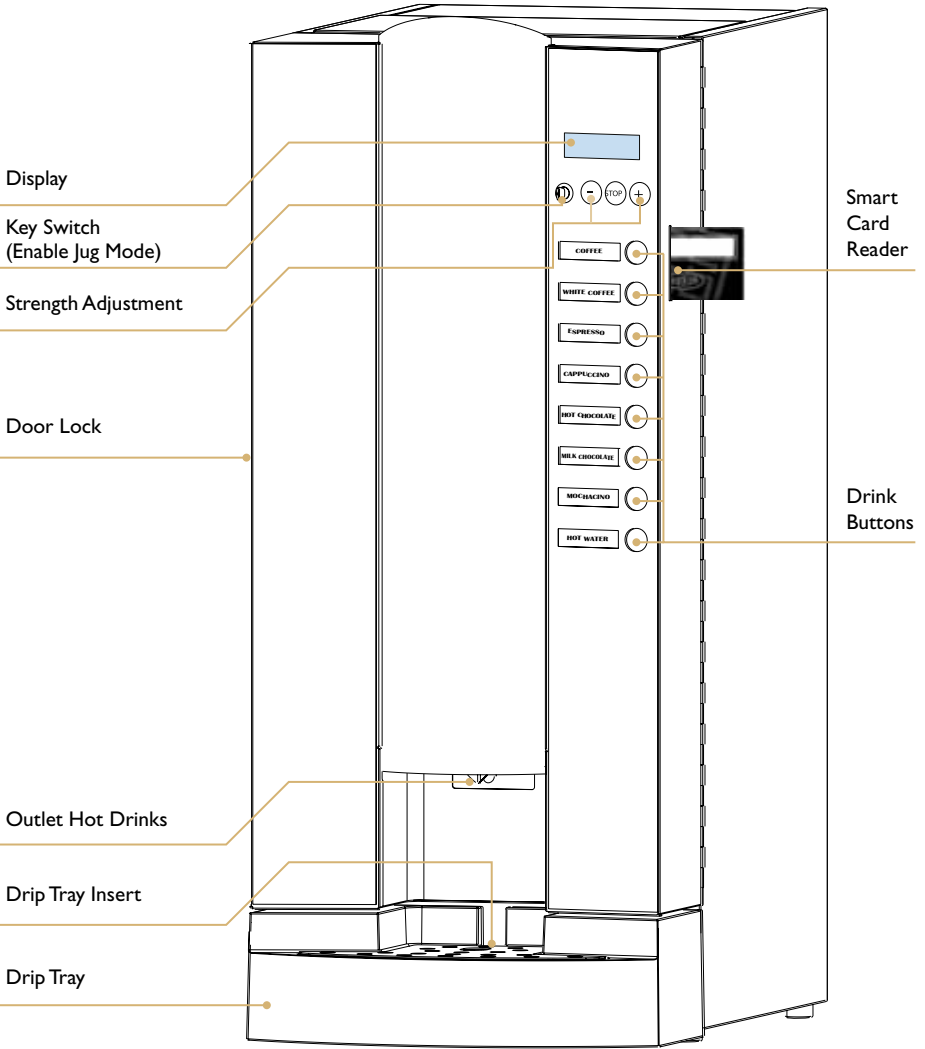

Front interior of Elite II

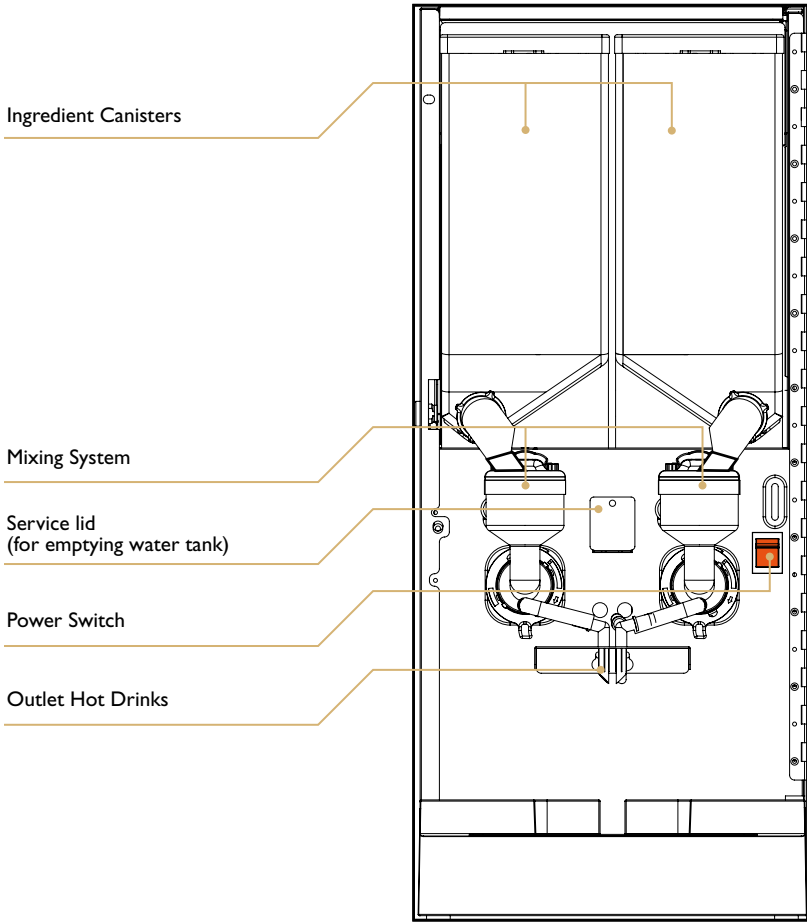

Ingredient canisters

DETAIL	INGREDIENTS	WIDTH	DEPTH	HEIGHT	CAPACITY	CUPS/UNIT
Canister	Coffee	137mm	335mm	225mm	5.4L	~675 cups
Canister	Topping	137mm	335mm	225mm	5.4L	~540 cups

Front interior of Elite III

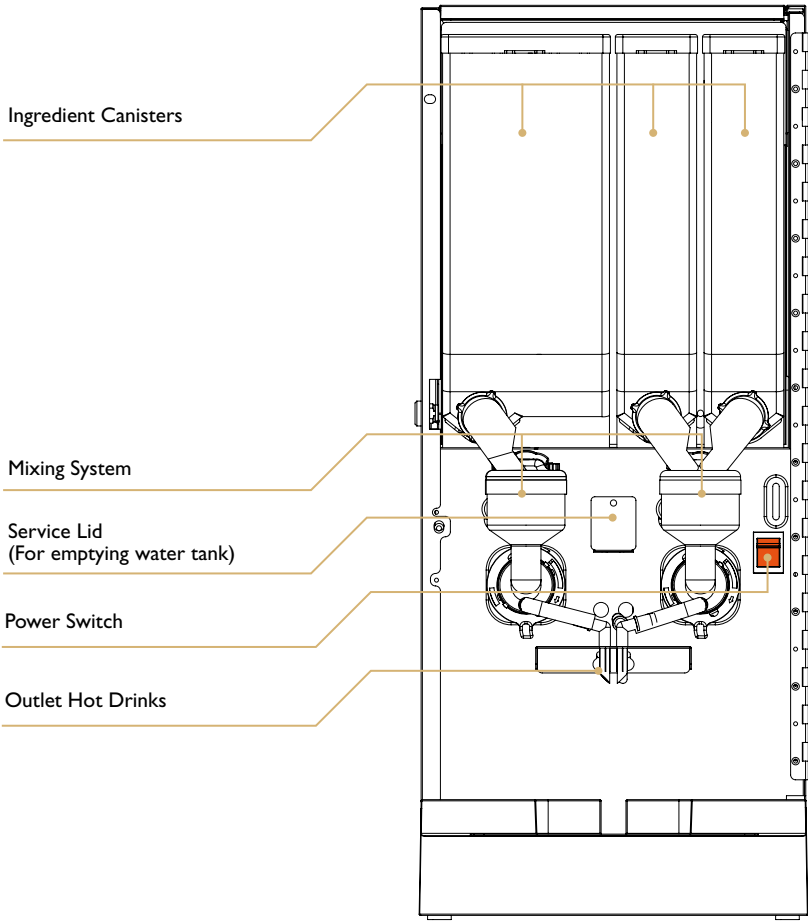

Ingredient canisters

DETAIL	INGREDIENTS	WIDTH	DEPTH	HEIGHT	CAPACITY	CUPS/UNIT
Canister	Coffee	137mm	335mm	225mm	5.4 L	~675 cups
Canister	Chocolate	67mm	335mm	225mm	2.7 L	~135 cups
Canister	Topping	67mm	335mm	225mm	2.7 L	~270 cups

Front interior of Elite IV

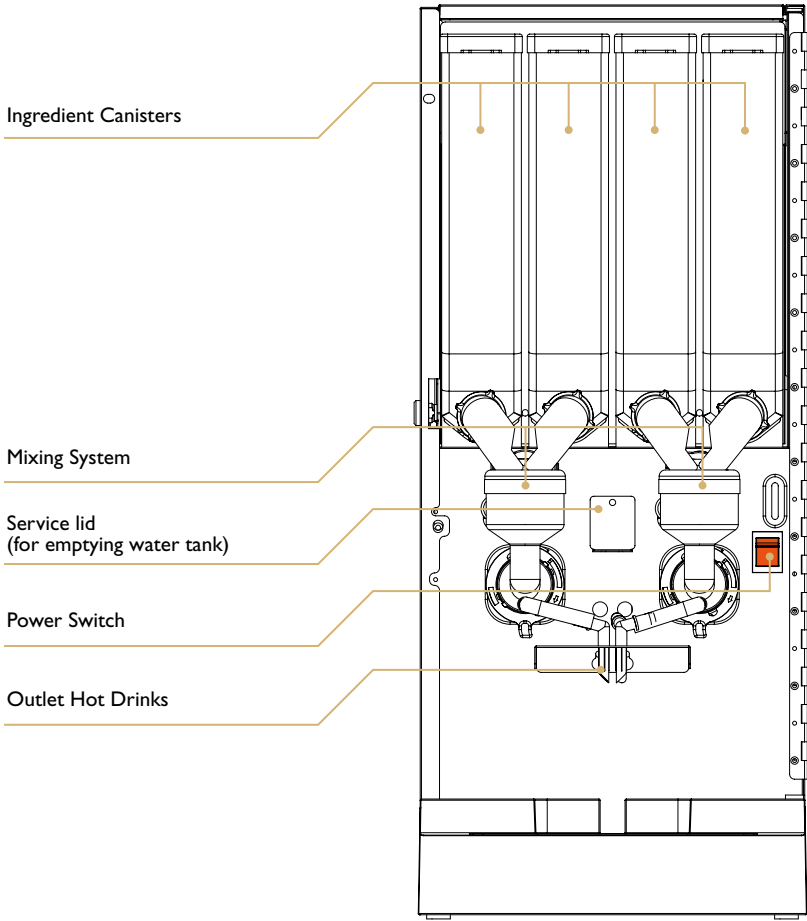

Ingredient canisters

DETAIL	INGREDIENTS	WIDTH	DEPTH	HEIGHT	CAPACITY	CUPS/UNIT
Canister	Coffee	67mm	335mm	225mm	2.7 L	~338 cups
Canister	Espresso	67mm	335mm	225mm	2.7 L	~600 cups
Canister	Chocolate	67mm	335mm	225mm	2.7 L	~135 cups
Canister	Topping	67mm	335mm	225mm	2.7 L	~270 cups

Membrane switch navigation

Button functions

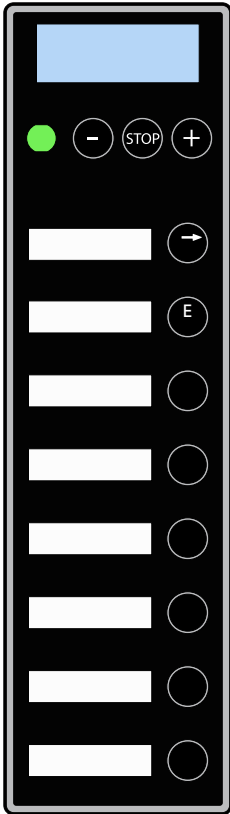

Press the BACK button if you want to leave the submenu and go back in the menu.



Press the ENTER button to select a menu function, confirm a set value or a setting. Confirm the new setting by pressing the E-button.



Press the MINUS button if you want to decrease a value or go back in the menu.



Press the STOP button if you want to return to the start menu.
To activate Energy Saving Mode press and hold the STOP button for 5 seconds. Display will show Energy Saving Mode. To return to normal mode press and hold the STOP button for 5 seconds while the machine is in energy saving mode.



Press the PLUS button if you want to increase a value or go forward in the menu.

ENERGY SAVING MODE

the machine switches off the front display and decreases the temperature in the water tank to 65°C.

Technical service card



- Technical service card is used for example cleaning of the machine and change different settings.
- The smart card is supplied by your dealer.

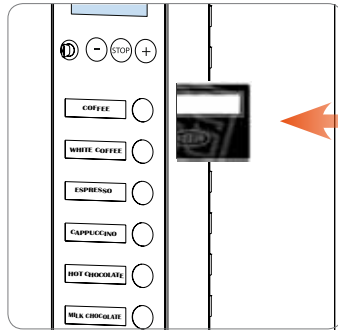

- Insert the technical service card with the chip facing towards the back of the machine. As in the figure above.

- The display will show the Service Menu, Clean Machine and you can now browse forwards through the menu.



- To use the machine again remove the technical service card and store it in a safe place.

Positioning

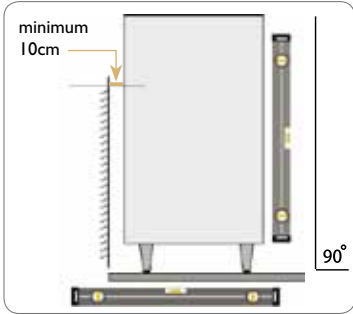

- Place the machine on a flat horizontal surface that will support the weight of the machine.
- Connect the electrical plug to a separate grounded wall socket.

Note Make sure air is able to circulate behind the machine (minimum 10cm).

Machine startup procedure

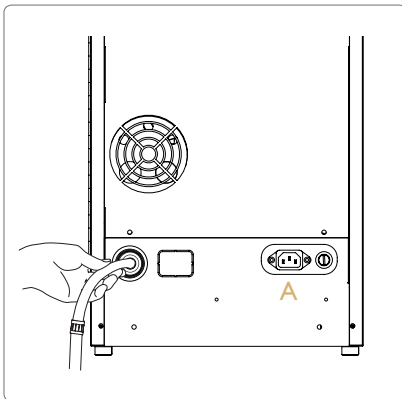

- Connect the water to the top cabinet on the machine.
- Connect the supplied water hose to the cold water connection using a ½” R-connection. When pushing the machine into position make sure there is no interference to the hose to ensure proper water flow.
- If the inlet hose is new, flush the system with water first to remove copper shavings. These can damage the inlet valve.
- The new tube set supplied with the appliance must be used. Old tubes may not be re-used. Connection to a closable valve is recommended.
- Min. water pressure; 2 bar (200kPa).
- Max. water pressure: 8 bar (800kPa).
- Open the water tap.

- Connect the mains cable to the machine (A) and insert the plug to a earthed wall socket.
- Switch on the power switch.

- The display indicates **Low Water Level Press Enter Key** Press the **E** button.

- The water tank will now automatically fill with 5 litres of water. The element will not be powered until the water reaches the level sensor.
- Set temperature is 85° Celsius.
- Once the water heating is complete “Low temp” text will disappear from the display. (The display text will start to rotate between these two screens **COFFEE QUEEN** and **AT YOUR SERVICE**)

Fill ingredient canisters

01

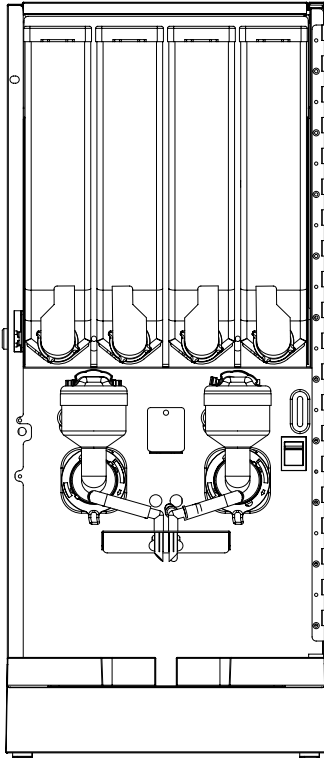

▲ Open the door.

- ▶ Reassembly canisters.
When placing the ingredient canisters, Ensure that the openings of the canister chutes point down toward the mixing bowl (B).

02

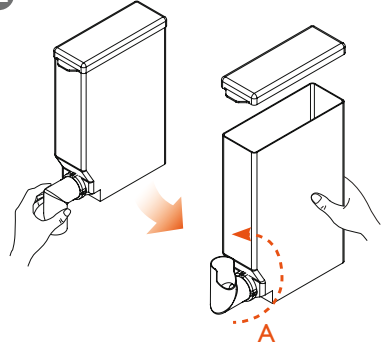

- ▲ Remove the ingredient canisters to avoid spilling in the machine and fill with ingredients .
When filling the ingredients, keep the opening of the canister chute upwards (A).

03

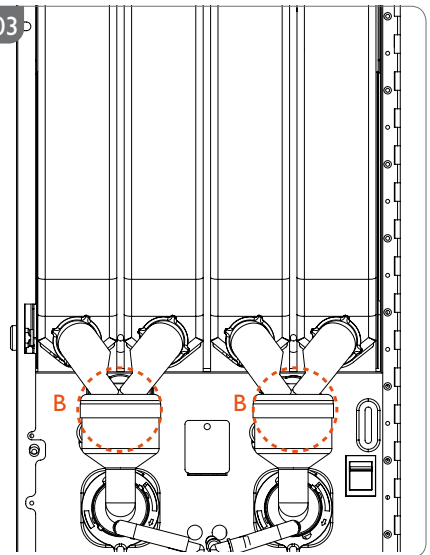

Dispensing drinks in a cup

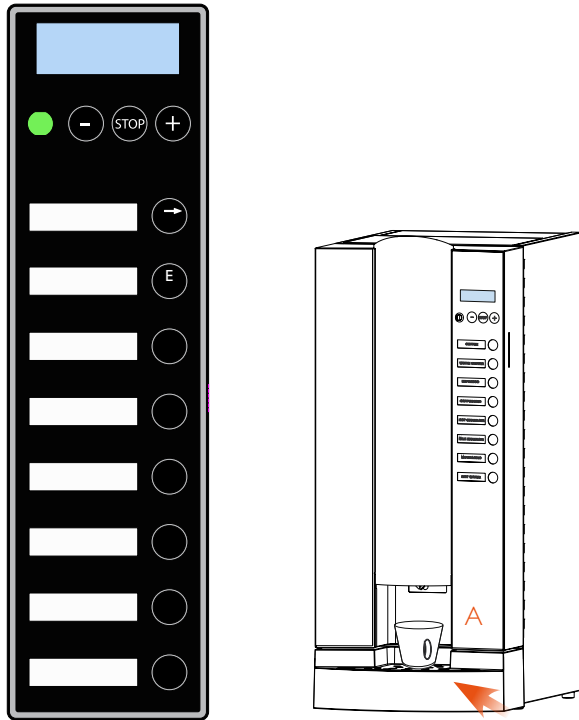



- Place a cup under the outlet for hot drinks.(A)
- The strength of the drink is set to default. If you would like to increase or decrease the strength then follow the steps in the section below.

Stronger drink, Press the  button

or

Weaker drink, Press the  button

- Choose drink.
- The display shows:  and the cup light goes on.

- Wait until the cup light switches off and the text  has disappeared from the display before removing the cup.

Dispensing drinks in a jug

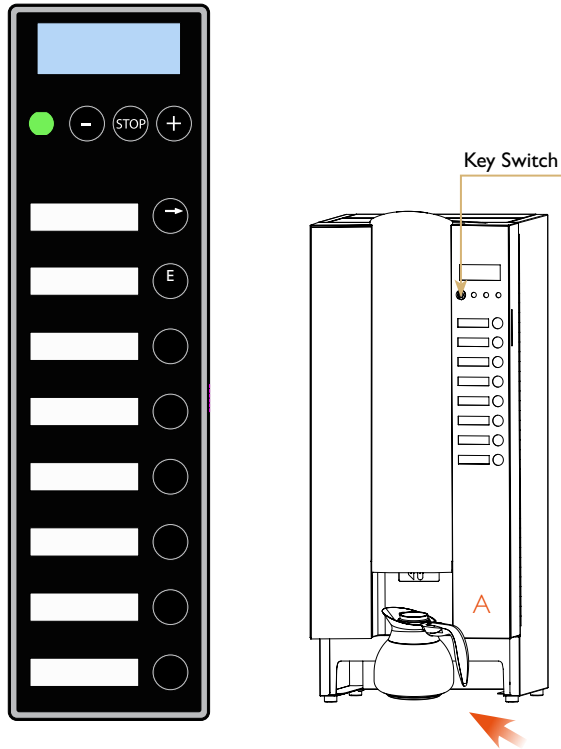

- Turn key switch to enable jug mode.
- Place a jug under the outlet for hot drinks.(A)
- The strength of the drink is set to default. If you would like to increase or decrease the strength then follow the steps in the section below.

Stronger drink, Press the  button
or

Weaker drink, Press the  button

- Choose drink.
- Wait until the cup light switches off and the message 

has disappeared from the display before removing the jug.

- You can abort the jug process by pressing STOP button any time during the process, it will finish the drink in process before complete stop.
- Turn back the key switch to its original position to exit jug mode.

Daily cleaning

Automatic rinsing of the mixing bowl

Cleaning means rinsing with water and rotating the whipper.

Cleaning of the mixing bowl should be performed once per day.

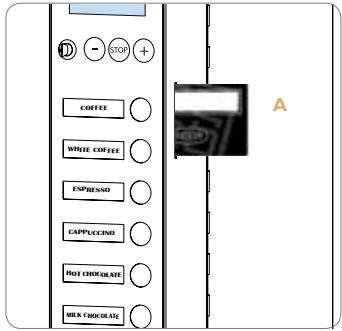
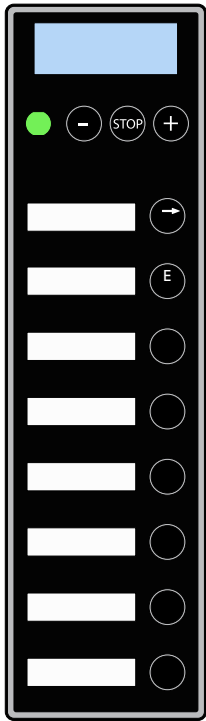

- Put a container that holds at least 0.5 litres under the outlet for hot drinks.
- Insert smart card in the card reader (A).
- Move through the menu until the display shows **Service Menu Clean Machine**

Press the **E** button.

- Move through the menu until the display shows **Service Menu Clean Mixer**

Press the **E** button.

- The machine will now clean the mixing bowls for 5 seconds.
- Remove smart card.

Note Repeat the cleaning procedures 2-3 times to get a better cleaning effect.

Daily cleaning

Automatic cleaning of dispenser valves

Cleaning entails that the valves “knock” off any lime scale and other particles that may get stuck in the cylinders and flushing them with water.

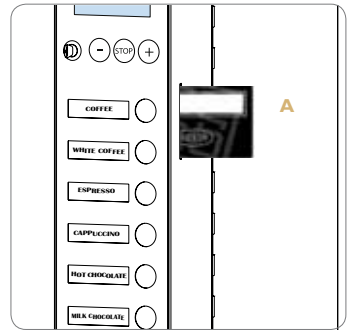
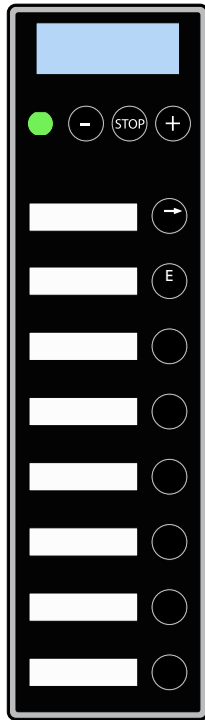

- Put a container under outlet for hot drinks.
- Insert smart card in the card reader (A).
- Move through the menu until the display shows



Press the  button.

- Move through the menu until the display shows



Press the  button.

- Dispenser valves will now start to open and close with 3 pulses/second for a max of 6 seconds. Repeat the procedure 2 - 3 times.
- Remove smart card.

Note

Repeat the cleaning procedures 2-3 times to get a better cleaning effect.

Weekly cleaning

Disassemble mixing system

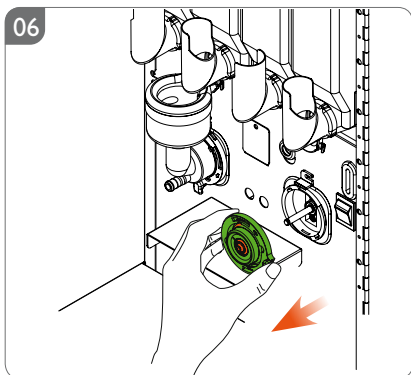
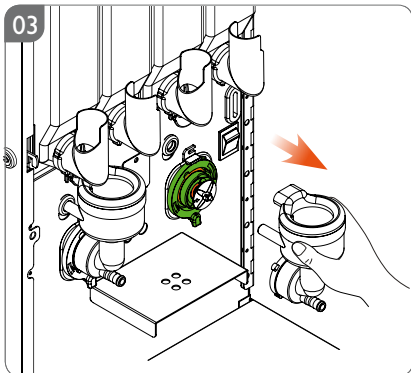
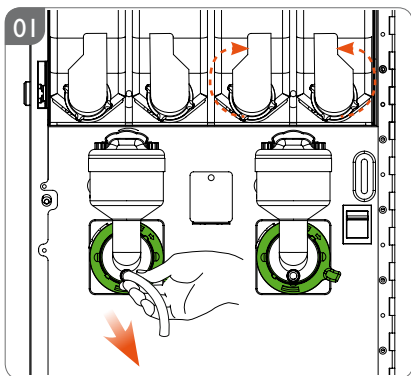

▲ Pull the mounting plate straight out.

◀ Keep the opening of the canister chute upwards, and pull out the outlet hose.

▼ Turn the mounting plate lever anticlockwise.

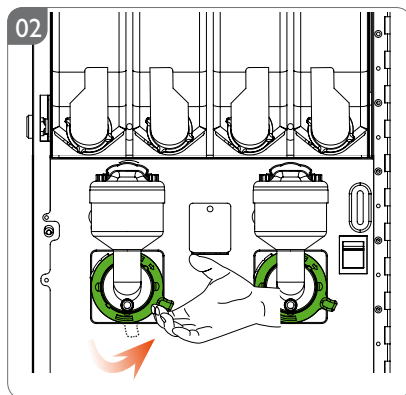

◀ Loosen the mixing bowl by pulling it straight out.

▼ Loose the whipper by pulling it straight out.

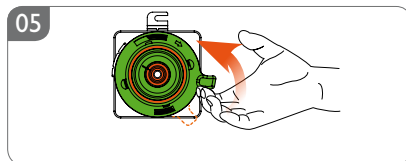
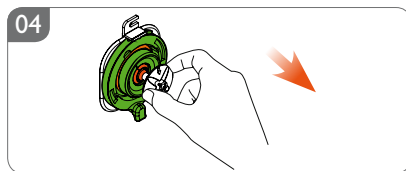

▲ Loosen the mounting plate. Turn the lever anticlockwise, until it stops.

Reassembling mixing system
See the next page

Weekly cleaning

Wash these parts



Mixing bowl



Condensation trap



Mounting plate



Whipper



Clean with a moist cloth and wipe dry.

★ All parts must be dry before reassembly.

Reassemble mixing system

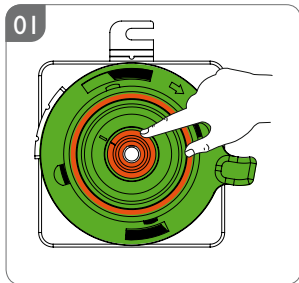

▲ Check all seals (red) before reassembly of parts.

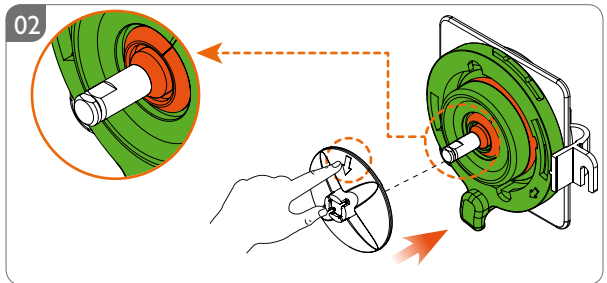

▲ The flat side of the whipper shaft must correspond with the marked arrow on the whipper.

To fit the whipper push onto the shaft until a click sound can be heard. It is only possible to assemble the whipper in one way.

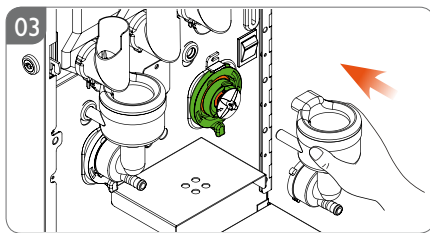

◀ Fix the mixing bowl and condensation trap. Push-fit the mixing bowl and fix with lever.

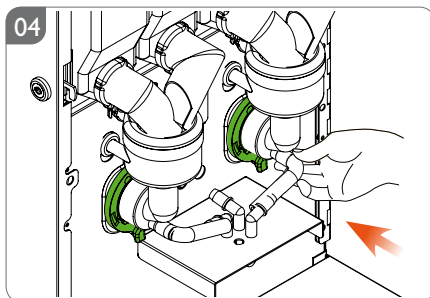

◀ Connect the outlet hose.

Note Ensure that all water hoses have been connected and fitted.

Failure message

Failure messages which can mostly be corrected without any help from service company.

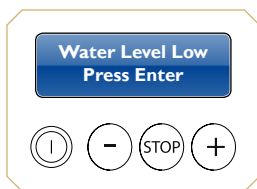

- Display shows  Check if water tap is open.

Then press the  button.

- Display shows normal, but no drink is coming.
Possible cause of failure:
Mechanical stop in the ingredients canisters or mixer unit.

Action: Try to find the cause of failure. Clean the mixer system and try again.

Storage / Transport

Preparation for transportation or long term storage

- Turn off the switch, pull out the electric plug and close incoming water tube.
- Long machine storage at temperatures below 0°C can cause damage of the machine.
- Empty all the water in the machine by opening the service lid between the mixer bowls. Pull out the hose, remove the plug and let all water pour out. Reassemble the plug and lid.

Exterior cleaning

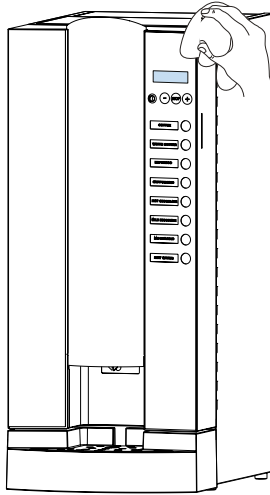

- Cleaning the outside
- Use a soft rag and liquid cleaning agent to prevent scratches.

Note The machine must not be covered with or immersed in water.

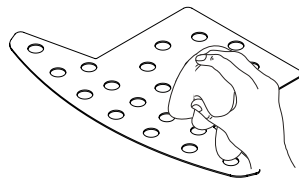
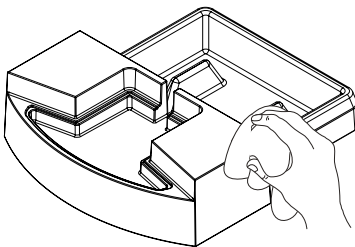

- To be washed as needed
- Drip tray and drip tray insert should be washed by hand in ordinary dishwasher.
- Do not wash in a dish washing machine!

Message on display	Indication
Not Available	Drink can not be selected as pot.
Heating Water Please Wait...	Low temperature in the water tank, the machine is heating up (blocked).
Low Water Level Press Enter Key	Low water level in water tank. Press enter key to start filling up the water tank.
Filling Water Please Wait...	The machine is filling water.
Temperature	Shows actual temperature in water tank
Energy Saving Mode	The machine is in energy saving mode.
Warning Low Temperature	Temperature is low, it is still possible to dispense drink.
Low Temperature Blocked	Temperature is low, the machine is blocked.
Empty Drip Tray	The drip tray is full of water.
Overcurrent	Overcurrent, some component is using too much current, try to locate the component and replace it.
Error: Water Supply	The water has not reached the correct level in the water tank. Check the water tap, restart the machine.
Error: Water Level Pins	Check the level sensor, cable failure, level pins connected incorrectly, too much scale or residue on the level pins.
Bev. Disabled	The drink has been disabled
Please Wait	Shows when drink is dispensing
Door Open	The door is open, Close door to proceed.
Error: Temp.Sensor	Tempsensor damaged, faults in cables
Error: Check Heater	Solid state defect, heater defect. Output on I/O board is defect.

Activate programming with smart card

- Insert the technical service card in the card reader(A).
- Display shows 

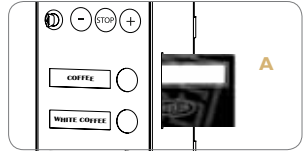

Buttons function



Press this button if you wish to leave the submenu and return to the main menu.



Press the ENTER button if you want to enter a menu, alter the value or a setting.

Alter a value by pressing the  or  button.

Confirm the new setting by pressing the E-button.



Press this button if you wish to increase a value or step forward in the menu.



Press this button if you want to reduce a value or go back in the menu.



Press the STOP button if you wish to return to the service menu.

Note Values displayed in this section as ### is fixed values for display. Values displayed in this section as <XXX> can be changed.

Main menu

Overview

Service Menu
Clean Machine

Press  to go forward

Service Menu
Counters

Press  to go forward

Clean machine

Perform cleaning of the machine.

Service Menu
Clean Machine

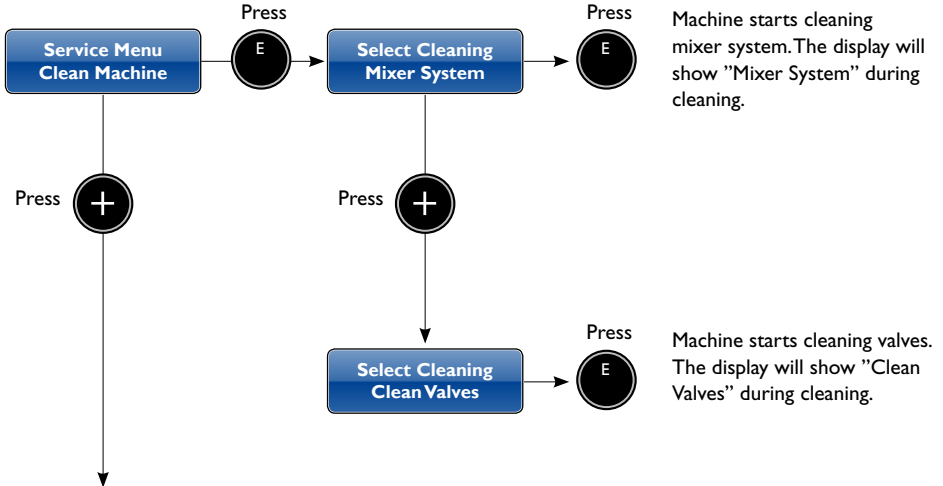

Counters

See the counter of each drink or total counters for all drinks. It's also possible to reset the drink counters.

Service Menu
Counters

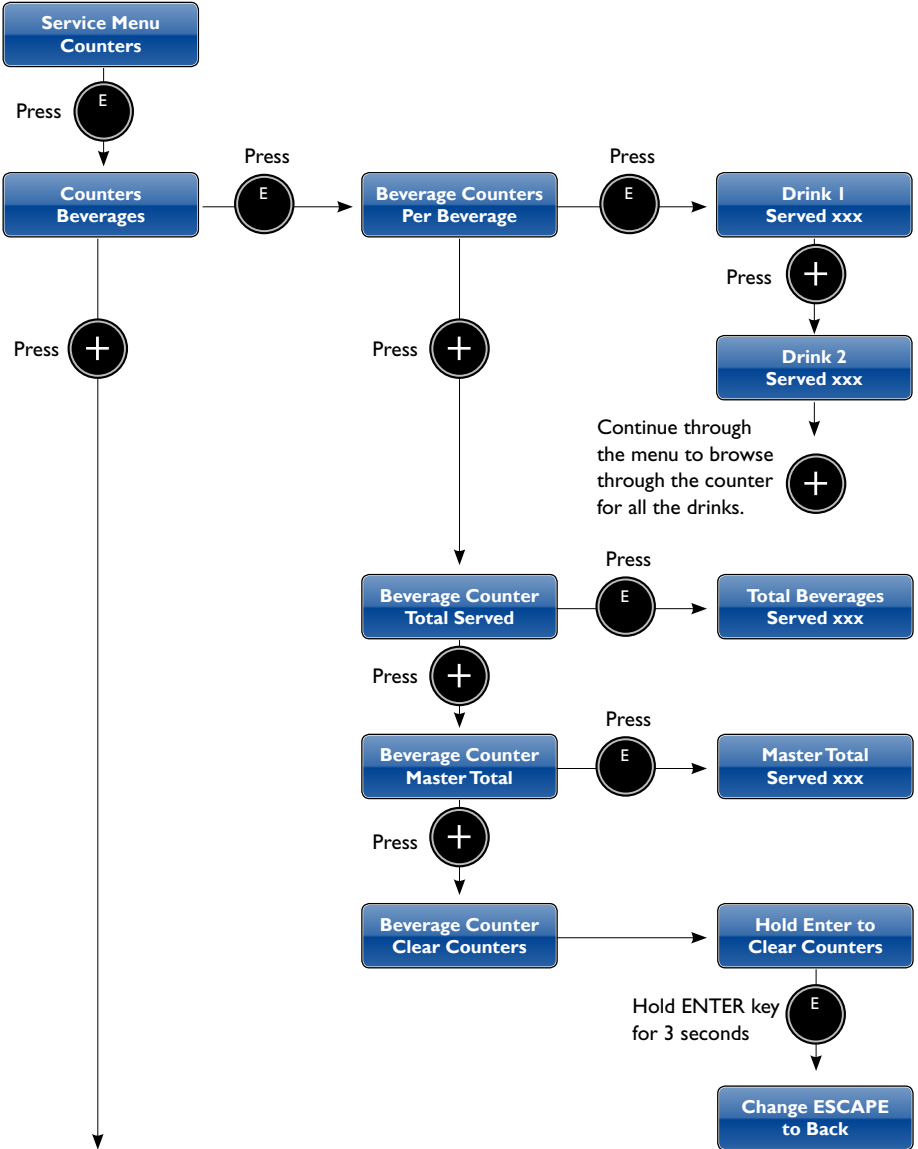

Counters

See the number of times cleaning has been performed or reset the clean counter.

**Service Menu
Counters**

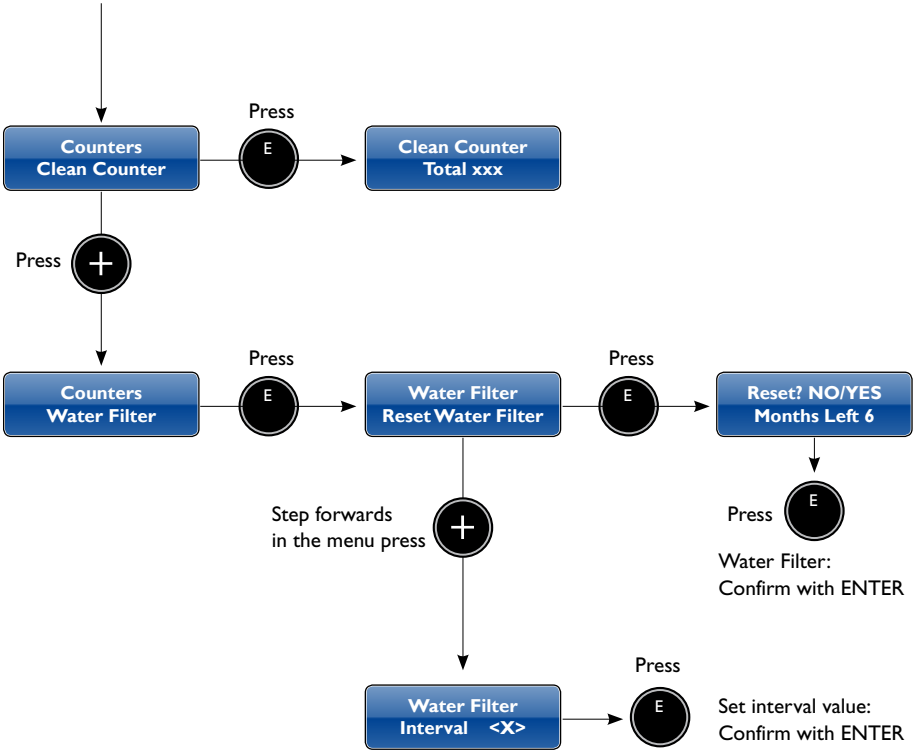

Café Elite

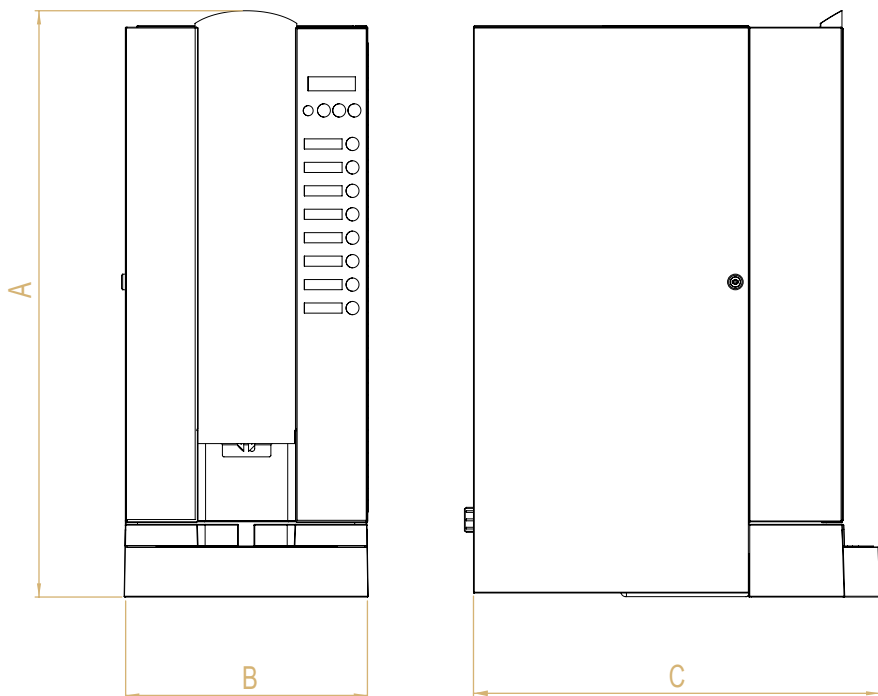

Model	A	B	C
Café Elite II	735mm	310mm	515mm
Café Elite III	735mm	310mm	515mm
Café Elite IV	735mm	310mm	515mm

For the warranty to be valid the conditions for maintenance must have been followed according to our instructions, proper precaution has been made and warranty claim been issued without delay.

The affected equipment may not be used during awaiting service if there is any risk that the damage or defect would worsen.

The warranty will not cover consumption supplies such as glassware, normal maintenance such as cleaning of filters, contaminations in water, lime, incorrect voltages, pressure or adjustment of water amounts.

The warranty will not cover damages of defects caused by incorrect handling and operation of the appliance.

FOR SERVICE

Please contact your dealer

Your Dealer

