

I

## ROMPIGHIACCIO TRITAGHIACCIO

MANUALE D'USO E MANUTENZIONE

GB

## ICE CRUSHER AUTOMATIC ICE CRUSHER

INSTRUCTION AND MAINTENANCE MANUAL

F

## BROYEUR À GLACE PILEUR À GLACE

MANUEL D'UTILISATION

D

## EISZERKLEINERER AUTOMATIK- EISZERKLEINERER

BEDIENUNGS- UND WARTUNGSANLEITUNG

E

## PICADORA DE HIELO TRITURADOR DE HIELO

MANUAL DE USO Y MANTENIMIENTO

V90

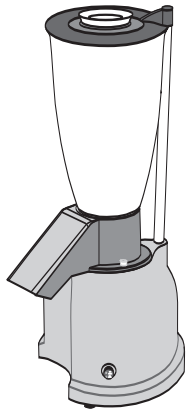

V100

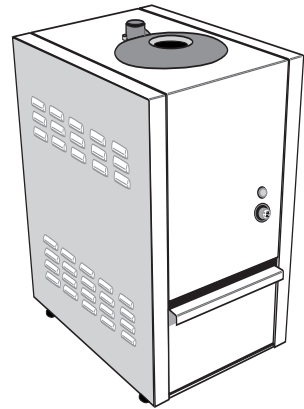

G30

## ROMPIGHIACCIO V90 e V100 - TRITAGHIACCIO G30

**V90** e **V100** sono due tritaghiaccio per la produzione di ghiaccio a scaglie per cocktail.

Il **Tritaghiaccio G30** è un apparecchio professionale per la preparazione di ghiaccio per granatine.

Come tutti gli elettrodomestici deve essere utilizzato con particolare prudenza per evitare lesioni alle persone e danni all'apparecchio.

Leggere perciò con cura le presenti istruzioni per l'uso prima della messa in funzione ed attenersi alle prescrizioni relative alla sicurezza.



**Non utilizzare l'apparecchio se non si conoscono adeguatamente le istruzioni per l'uso!**

I

Pagina 4

## ICE CRUSHER models V90 and V100 AUTOMATIC ICE CRUSHER model G30

**V90** and **V100** are two ice crushers for the production of crushed ice for cocktails.

The **Automatic Ice Crusher G30** is a professional appliance for preparing ice for slushes.

Like all appliances, it should be used with particular care to avoid injury to the personnel and damage to the appliance.

It is therefore essential to read these instructions carefully before using the appliance and to follow the safety recommendations.



**Do not use the appliance if you are not sufficiently familiar with the instructions!**

GB

Page 12

## BROYEUR À GLACE V90 et V100 - PILEUR À GLACE G30

Le **V90** et le **V100** sont deux broyeurs à glace pour obtenir de la glace pilée pour les cocktails.

Le **Pileur à glace G30** est un appareil professionnel pour la préparation de glace pilée pour granatinés et cocktails.

Comme tous les appareils électroménagers, ils doivent être utilisés avec une prudence particulière pour éviter les blessures aux personnes et les dommages à l'appareil.

Lire attentivement les présentes instructions d'utilisation avant la mise en fonction de l'appareil et observer toutes les instructions concernant la sécurité.



**Ne pas utiliser l'appareil sans connaître correctement les instructions d'utilisation !**

F

Page 20

## ICE CRUSHER V90 and V100

### Main parts of model V90 (Fig. 1)

- |          |               |          |                 |
|----------|---------------|----------|-----------------|
| <b>1</b> | Motor housing | <b>5</b> | Magnetic sensor |
| <b>2</b> | Container     | <b>6</b> | Safety arm      |
| <b>3</b> | Lid           | <b>7</b> | ON-OFF switch   |
| <b>4</b> | Filler cap    | <b>8</b> | Spout           |

### Main parts of model V100 (Fig. 2)

- |          |           |          |                 |
|----------|-----------|----------|-----------------|
| <b>1</b> | Housing   | <b>5</b> | Magnetic sensor |
| <b>2</b> | Tray      | <b>6</b> | ON-OFF switch   |
| <b>3</b> | Container | <b>7</b> | Indicator light |
| <b>4</b> | Lid       |          |                 |

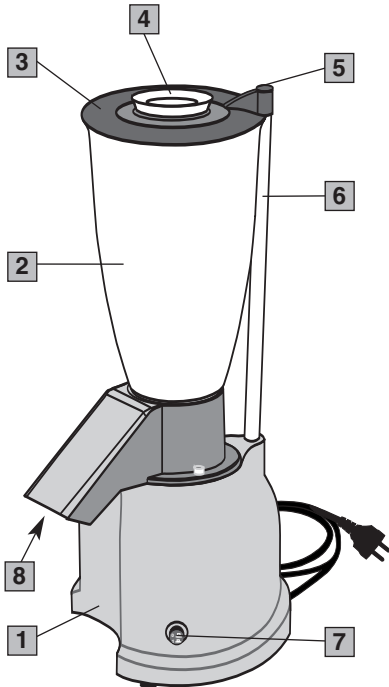

Fig. 1

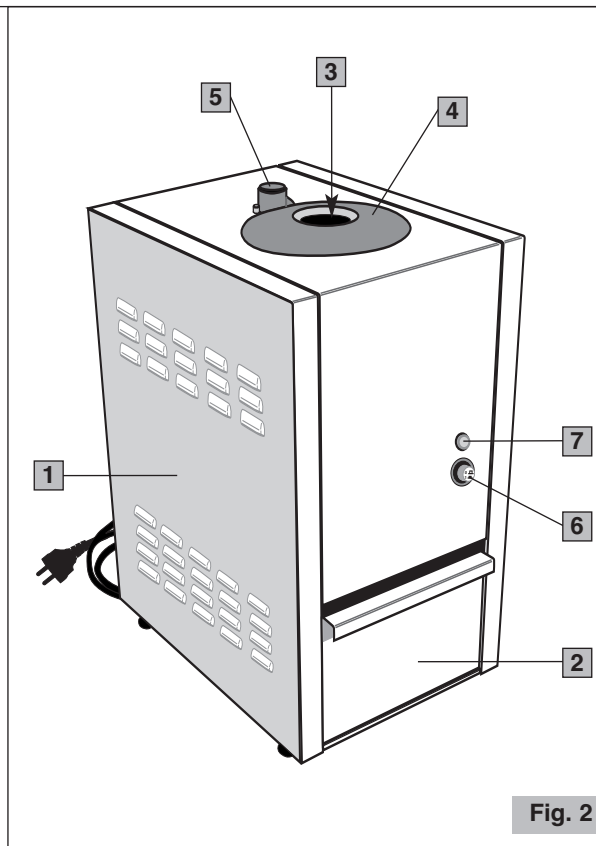

Fig. 2

## AUTOMATIC ICE CRUSHER G30

### Main parts (Fig. 3 - Fig. 4)

- |   |                               |    |                   |
|---|-------------------------------|----|-------------------|
| 1 | Housing                       | 6  | Ice presser cover |
| 2 | Inlet                         | 7  | Blade             |
| 3 | Lever with safety microswitch | 8  | Water drain       |
| 4 | Bowl                          | 9  | Bowl housing      |
| 5 | ON-OFF (I-O) switch           | 10 | Spout             |

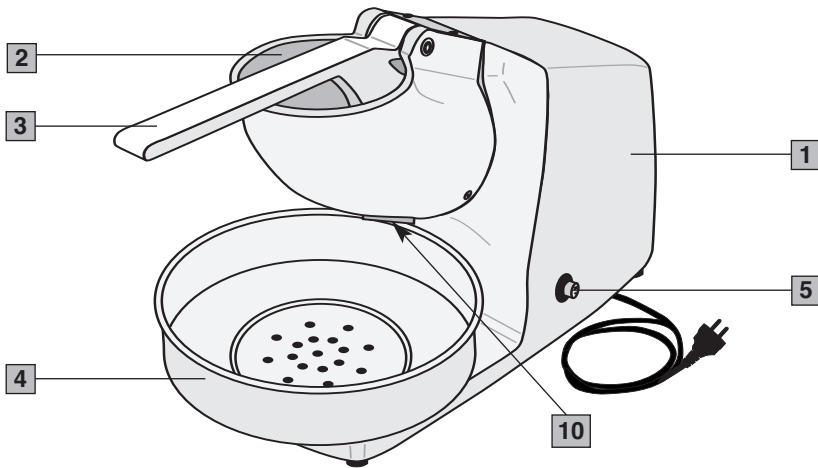

Fig. 3

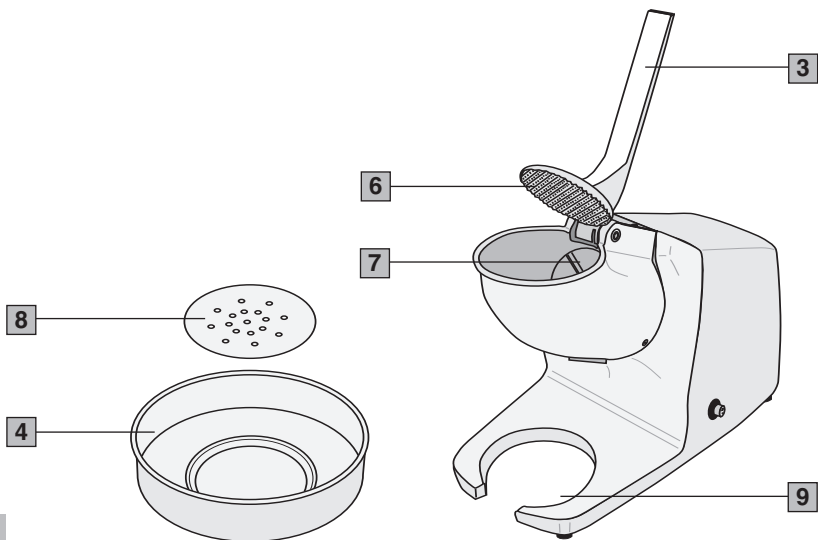

Fig. 4

## SAFETY RECOMMENDATIONS

### GENERAL INSTRUCTIONS

1. Read the following instructions carefully before using the appliance.
2. Installation and any maintenance should be carried out by specialized personnel.
3. This appliance is intended for professional use, and should therefore be used by adults and qualified personnel only.

#### **CLOSE ADULT SUPERVISION IS NECESSARY WHEN CHILDREN ARE NEAR THE APPLIANCE.**

4. **Never** use this appliance for any operations other than crushing ice cubes. Any other use is dangerous.
5. Always work under safe conditions: do not use the appliance with wet hands or feet. **Do not use outdoors.**
6. Keep the original package for possible future use. It is the most suitable protection against impact during transportation.
7. In case of fire use CO<sub>2</sub> extinguishers. Do not use water or powder extinguishers.
8. **Never** place the appliance in water!
9. Do not disassemble the appliance or attempt to perform any repairs inside it.
10. Always unplug the appliance before performing any maintenance or cleaning and when it is not in use.
11. **Never** pull the appliance by the cord to move it. **Never** unplug it by pulling the cord or touching it with wet hands.



**If the cord is damaged, it must be replaced by an Authorized Service Center.**

12. The appliance is equipped with a safety device to prevent any contact with moving parts. **DO NOT ATTEMPT TO BY-PASS THE SAFETY DEVICE.**
13. **WARNING:** Never place any utensils, metal or other hard materials, in the container. This is dangerous and could cause damage.
14. **Do not** use the appliance if it is damaged or had any loosened parts such as blades, couplings, etc. In these cases, contact an Authorized Service Center immediately.
15. **WARNING: BLADES ARE SHARP. HANDLE WITH CARE!**

**SAVE THESE INSTRUCTIONS!**

## INSTALLATION

Comply with the **safety recommendations** indicated above and hereafter when installing the appliance.

1. Make sure that the mains voltage is as indicated on the rating label of the appliance and that the electric system is grounded and equipped with a differential switch.
  2. Install the appliance in a **DRY, PROTECTED place**, far from water sprays or splashes, heat sources, open flames and inflammable substances.  
Place the appliance on a **flat, horizontal, stable surface** where it cannot tip over.
  3. Make sure the switch on the appliance is in the "OFF" position and plug it into a socket protected by a magneto thermal switch or fuses.  
**Do not use a multiple outlet plug.**
  4. Stretch the power cable out to full length. **Do not** let it pass over sharp edges or hot surfaces. **Do not** let oil spill on it. **Do not** let the power cable hang loose from the counter on which the appliance stands.
- 

## USE

### Models V90 and V100

- 1 Make sure the switch is in the "OFF" position.
- 2 On model V90, place an empty container under the spout.
- 3 Place the ice cubes in the container.
- 4 On model V90, fit the lid on the container so that the magnetic sensor is in contact with the end of the safety arm (Fig. 5). On model V100, fit the lid so that the magnetic sensor is between the two positioning screws (Fig. 6).



**Any attempt to by-pass the safety device and use the appliance without its lid may cause personal injury and/or damage to the appliance.**

- 5 Start the motor by turning the switch to "ON". Run the appliance for the time necessary to crush the ice in the container (about 30 seconds are needed to crush a full container).
- 6 Switch the motor off by turning the switch to "OFF".

**Note:** Always wait for the motor to come to a complete stop before removing the lid.

---

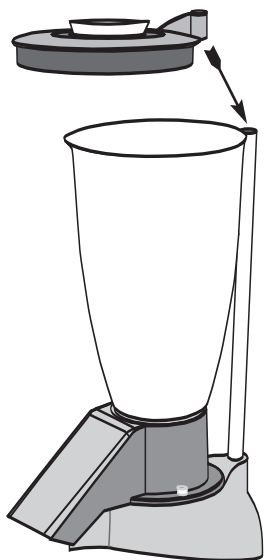

Fig. 5

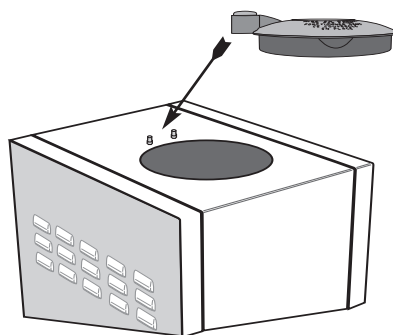

Fig. 6

- 7** Model V100: if the device is not switched off with the switch, replacing the tray will start the motor again.

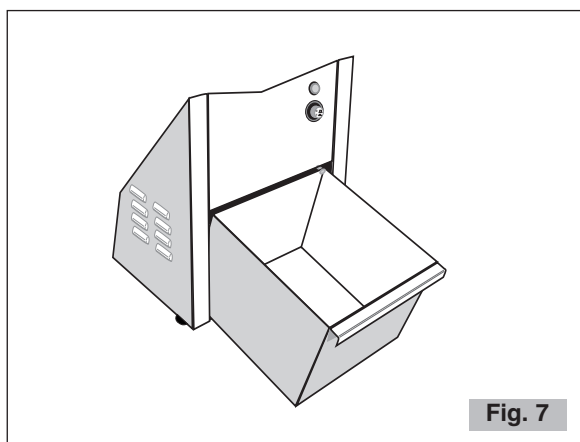

Fig. 7

## Model G30

- 1** Prepare a container with the ice cubes to be crushed.
- 2** Place the bowl under the crushed ice spout.
- 3** Lift up the lever, pour the ice cubes into the inlet.

- 4 Start the appliance by operating the ON-OFF switch.
- 5 Lower and push on the lever steadily without forcing.
- 6 Repeat the above procedure as many times as necessary.
- 7 After use, stop the motor by turning the switch to "OFF".

**Note:** The lever with the ice presser cover is equipped with a safety microswitch that stops the motor when the lever is raised (Fig. 8). The fact of lifting the lever to add more ice cubes in the inlet will therefore stop the motor without switching off the appliance. When the lever is lowered again the motor starts.

**!** Any attempt to by-pass the safety device may cause personal injury and/or damage to the appliance.

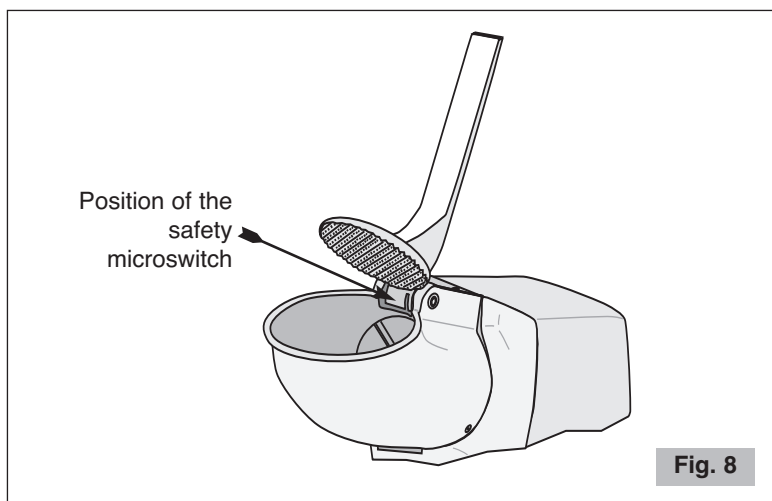

## CLEANING AND MAINTENANCE

It is important to keep the appliance clean and in good working order to ensure optimum quality of the products and long life of the appliance.

- **To clean the appliance**, unplug the appliance and clean with a damp cloth or alcohol, or use a generic spray detergent.  
Dry with a dry cloth.

**!** Never wash the appliance with jets of water or immerse the motor housing.

**!** Models V90 and V100: Do not expose the lid to temperatures above 60°C. This would damage the magnetic sensor.



## TROUBLESHOOTING

In case of any malfunction, defect of the appliance or if you suspect any breakage after a fall, unplug the appliance immediately.

If you are unable to solve the problem referring to the table below, contact an Authorized Service Center.

**Only qualified experts should repair the appliance.**

We are not liable for any damage caused by repairs not made correctly by unauthorized personnel. In these cases the warranty does not apply.

Problem	Solution
The ice crusher does not start.	<ul style="list-style-type: none"> <li>• Make sure it is plugged in.</li> <li>• Make sure the safety circuit breaker is closed.</li> <li>• On models V90 and V100, make sure the magnetic sensor in the lid is in the correct position.</li> <li>• Make sure the switch on the appliance is turned to ON.</li> <li>• On model V100, make sure the tray is in the correct position.</li> <li>• If the problem occurs after a long period of intensive use the motor may have overheated. Wait at least 20 minutes and try again. If you put the appliance in a cool place this will reduce the waiting time.</li> <li>• If the problem occurs after an overload, the circuit breaker on the motor may have been tripped! Push the button on the back or bottom of the appliance (not standard equipment on all models).</li> </ul>

## DISPOSAL

### Correct disposal of this product (waste electrical and electronic equipment)

(Applicable in the European Union and other countries with separate collection systems)

This product has been made from high-quality parts and materials, which can be re-used and recycled.

Therefore, do not throw the product away with normal household waste at the end of its working life. Take it to a collection point for recycling electrical and electronic devices. This is indicated by this symbol on the product and in the operating manual.

Please contact your local government office for information about the exact location of the closer collection point.



## WARRANTY

This product is guaranteed against defects in the materials or manufacture for a period of two years from the date of purchase when used according to the instructions in this use and maintenance manual.

During the warranty period, this product can either be repaired or replaced, at the manufacturer's discretion, at no additional cost.

If the products needs maintenance or repairs during the warranty period, contact your retailer for shipping instructions. The product should be shipped in its original package or other suitable packing.

The warranty does not apply in case of neglect, improper use or unauthorized repairs. The warranty does not apply, also, to parts subject to wear such as the container, blades, joints, etc.

The warranty is limited to the costs of repair or replacement of the product or its defective parts, or an amount equivalent to the price paid for its purchase. No additional requests of damages will be considered.

---

The above instructions must be followed, otherwise the warranty is invalidated and the manufacturer has no liability.

In any case these instructions cannot cover every possible condition and the user is recommended to make responsible use of the appliance.

---

**THE MANUFACTURER RESERVES THE RIGHT TO MAKE ANY ALTERATIONS TO  
THE APPLIANCE WITHOUT NOTICE**

---